



Websters
estate agents

Little Queens Road, Teddington, TW11 0HR

Ground Floor 1 bedroom apartment in a popular and well maintained development with residents parking and access to communal gardens at the front and rear. Situated in a quiet residential area just 0.1 mile from Teddington town centre shops, cafes and restaurants and 0.4 miles from Teddington train station.

With no onward chain and tastefully presented to offer 482 sq ft of well balanced living space with modern fixtures and fittings, double glazed windows, built in storage and neutral decor throughout.

Front door opens into the hallway with storage and doors to the shower room, double bedroom and the living room with access to the fitted kitchen.

Located 0.4 miles from Bushy Park and within 0.9 miles of Teddington footbridge across the River Thames to Ham Lands and towpath walks towards Hampton Court and Richmond.

EPC Rating C

- Ground Floor 1 Bedroom Apartment
- Communal Gardens and Residents Parking
- No Onward Chain
- Tastefully Presented Throughout
- Well Balanced Living Space with Built in Storage
- 0.1 Mile from Teddington Shops and Cafes
- 0.4 Miles from Mainline Train Station



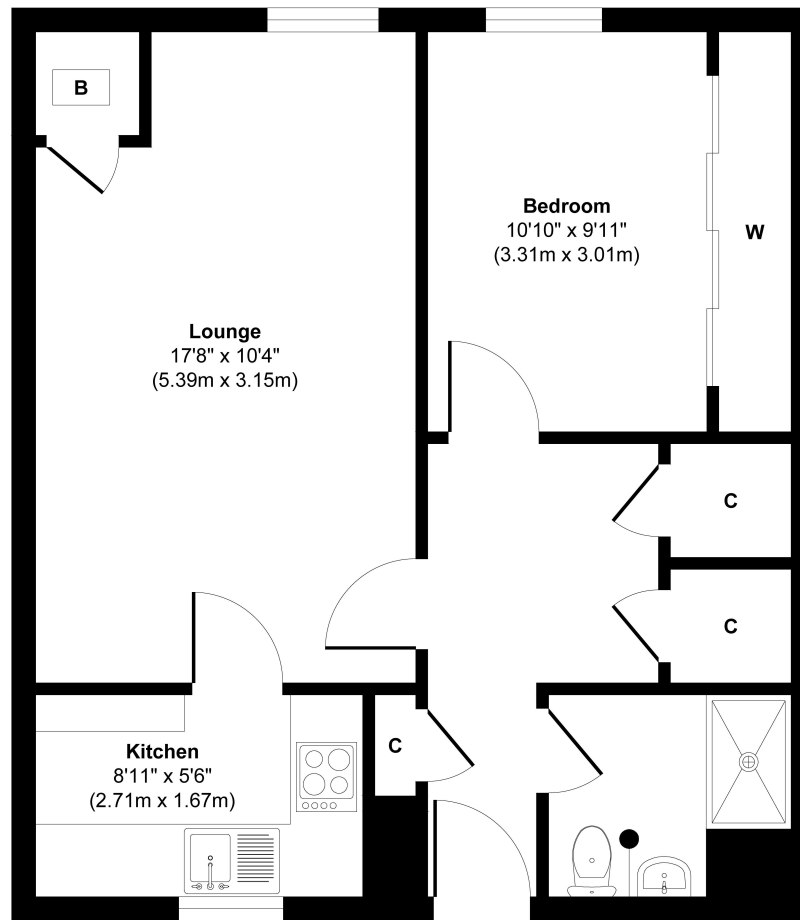

Floor Plan
Approximate Floor Area
482 sq. ft
(42.82 sq. m)

Shower Room
6'7" x 5'6"
(2.01m x 1.67m)

Approx. Gross Internal Floor Area 482 sq. ft / 42.82 sq. m

Disclaimer

These particulars, whilst believed to be accurate are set out as a general outline only for guidance and do not constitute any part of an offer or contract. Intending purchasers should not rely on them as statements of representation of fact, but must satisfy themselves by inspection or otherwise as to their accuracy. We have not carried out a detailed survey nor tested the services, appliances and specific fittings. Room sizes should not be relied upon for carpets and furnishings. The measurements given are approximate. No person in this firm's employment has the authority to make or give any representation or warranty in respect of the property.

