



Websters
estate agents

Stourton Avenue, Hanworth, TW13 6LE

First Floor 2 bedroom apartment in a popular residential development with communal gardens, well maintained internal areas and a private garage. Situated in a quiet cul-de-sac within 0.5 miles of local shops and bus transport links towards Heathrow, Richmond and Kingston.

Completely refurbished by the current owner to an impressive standard to offer 611 sq ft of well balanced living space with high quality fixtures, fittings and floorings, large double glazed windows and modern decor throughout.

Front door opens to the large entrance hallway with doors to the 2 double bedrooms, the luxury shower room and the living/dining room with access into the spacious kitchen with integrated appliances and a large built in storage area.

Located 0.7 miles from the A316 with direct access to the M3/M25 and into central London, 0.4 miles from Hampton Common and 0.9 miles from Hanworth Park.

EPC Rating D

- First Floor 2 Double Bedroom Apartment
- Private Garage and Communal Gardens
- Refurbished to an Impressive Standard
- 611 Sq Ft of Well Balanced Living Space
- Popular Residential Development
- 0.5 Miles from Local Shops
- Easy Access to London, M3 and M25 from A316



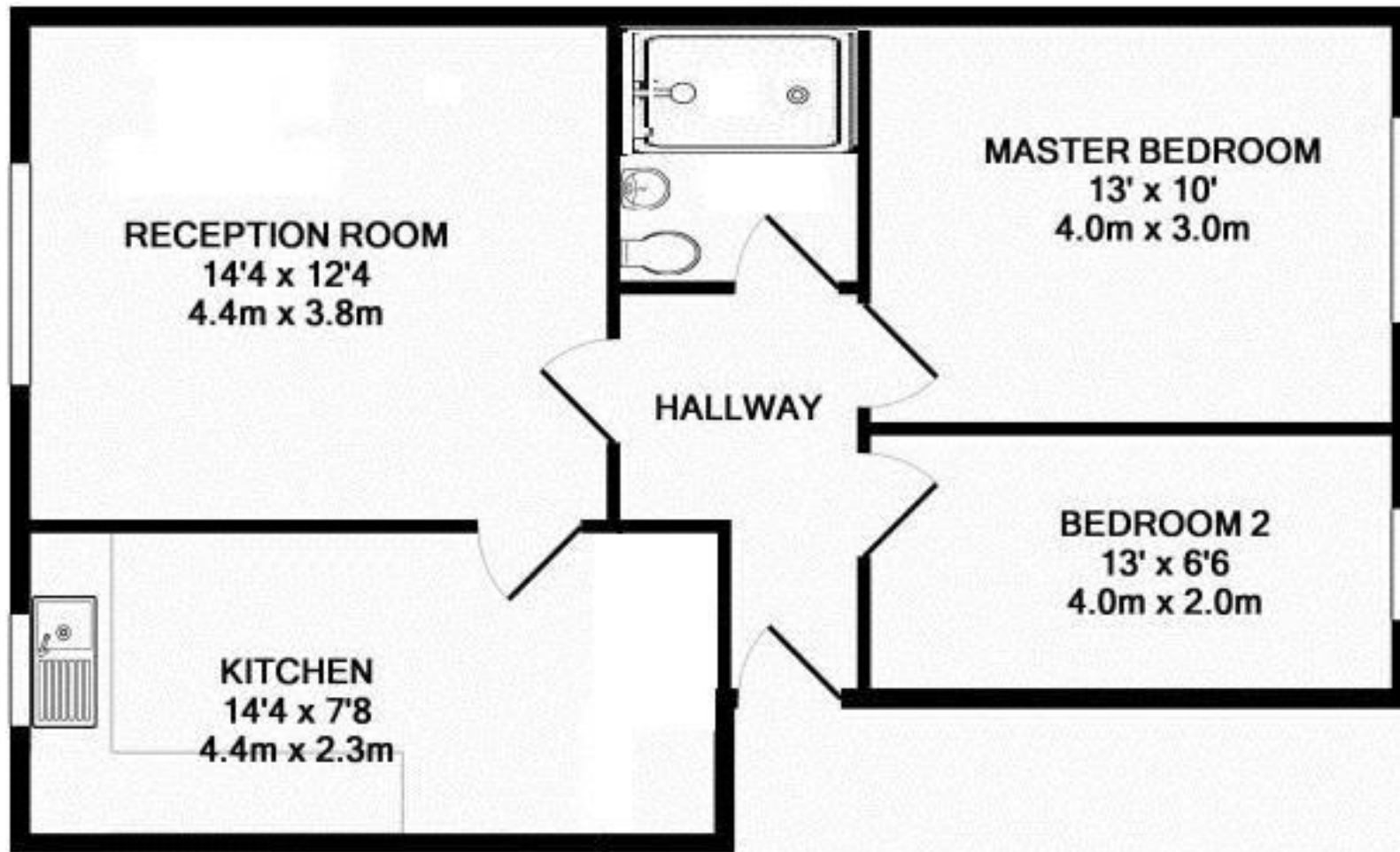

TOTAL APPROX. FLOOR AREA 611 SQ.FT. (56.8 SQ.M.)

a Websters Estate Agents 36 Broad Street, Teddington, Middlesex TW11 8QY

t 020 8614 6000

e sales@mywebsters.co.uk **w** mywebsters.co.uk

Disclaimer

These particulars, whilst believed to be accurate are set out as a general outline only for guidance and do not constitute any part of an offer or contract. Intending purchasers should not rely on them as statements of representation of fact, but must satisfy themselves by inspection or otherwise as to their accuracy. We have not carried out a detailed survey nor tested the services, appliances and specific fittings. Room sizes should not be relied upon for carpets and furnishings. The measurements given are approximate. No person in this firm's employment has the authority to make or give any representation or warranty in respect of the property.

