



Websters
estate agents

Lion Road, Twickenham, TW1 4JF

Mid Terrace 3 bedroom home with a west facing garden and an allocated parking space. Situated in a popular residential location just 0.2 miles from Twickenham Green, shops, cafes and restaurants. Situated within 0.4 miles of Archdeacon, TPA and St Richard Reynolds and less than 0.9 miles from Trafalgar, St James's and Waldegrave Girls/Co-ed Sixth Form.

With no onward chain and tastefully presented to offer 851 sq ft of living space over 3 floors with modern fixtures, fittings and floorings, double glazed windows and doors and neutral decor throughout.

Entrance lobby leads to the utility/storage room and the hallway with doors to the fitted kitchen and the living room at the rear. Double doors open onto the low maintenance west facing garden. On the first floor is the main bedroom with an en-suite shower room, the family bathroom and stairs leading up to 2 bedrooms on the second floor.

Located 0.6 miles from Twickenham town centre and train station, Strawberry Hill station, Church Street shops, restaurants and Twickenham Riverside with a towpath walk past Marble Hill Park to Richmond upon Thames.

EPC Rating C

- Mid Terrace Modern Build Home
- 3 Bedrooms and 2 Bathrooms
- Allocated Parking Space
- No Onward Chain
- 851 Sq Ft of Living Space over 3 Floors
- 0.2 Miles from Twickenham Green
- 0.6 Miles from Twickenham Station



Lion Road, TW1

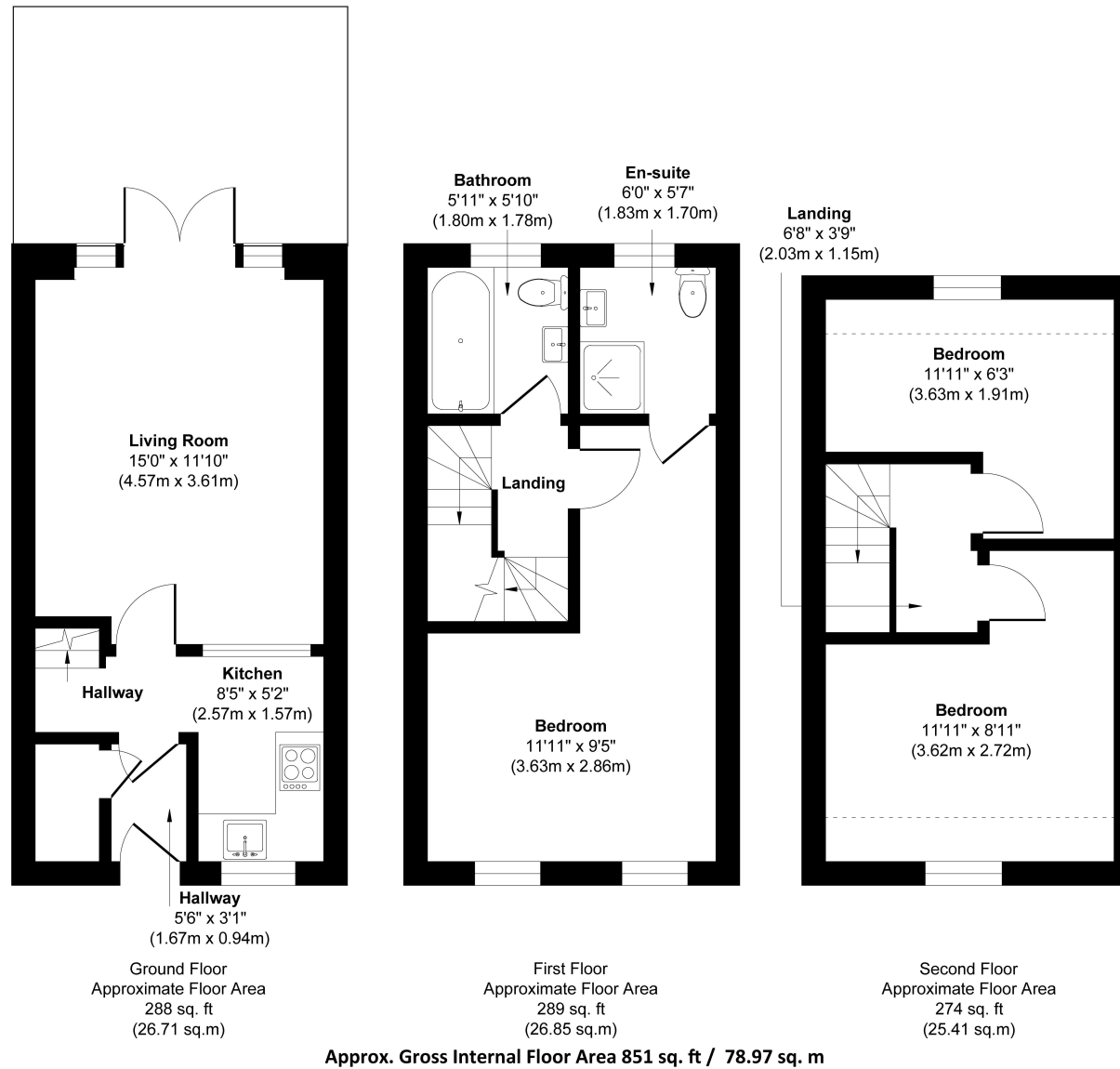

a Websters Estate Agents 36 Broad Street, Teddington, Middlesex TW11 8QY

t 020 8614 6000

e sales@mywebsters.co.uk w mywebsters.co.uk

Disclaimer

These particulars, whilst believed to be accurate are set out as a general outline only for guidance and do not constitute any part of an offer or contract. Intending purchasers should not rely on them as statements of representation of fact, but must satisfy themselves by inspection or otherwise as to their accuracy. We have not carried out a detailed survey nor tested the services, appliances and specific fittings. Room sizes should not be relied upon for carpets and furnishings. The measurements given are approximate. No person in this firm's employment has the authority to make or give any representation or warranty in respect of the property.

