



**DUDLEY GARDENS
W13**

£800,000 Offers In Excess Of

Northfields



DUDLEY GARDENS, W13

£800,000 OIEO



Reception/Dining Room



Kitchen/Breakfast Room



Three Bedrooms



Bathroom



Residents Permit

Enjoying a highly desirable location, this impressive Victorian family home effortlessly balances period charm with contemporary style. Showcasing three natural bedrooms with further potential to extend (STPP), a large reception dining room, extended kitchen breakfast area, downstairs WC, first floor family bathroom and a low-maintenance front & rear garden.

Situated in the heart of Northfields a short walk from Northfields Station & Lammas Park and just moments from the array of independent shops, cafes and restaurants on Northfield Avenue. Parents or those planning a family will be pleased to hear that the property falls within walking distance for the reputable Fielding Primary School.

EPC RATING: D

LOCAL AUTHORITY: Ealing

COUNCIL TAX BAND: E

You may wish to instruct us about a related service, including: the sale and letting of residential and commercial property, the provision of mortgage and financial services, conveyancing and property management. Where you choose to use other services, Northfields or its employees may receive a fee or commission which will be disclosed to you.

DUDLEY GARDENS

Approximate Gross Internal Area 1047 sq ft / 97.30 sq m

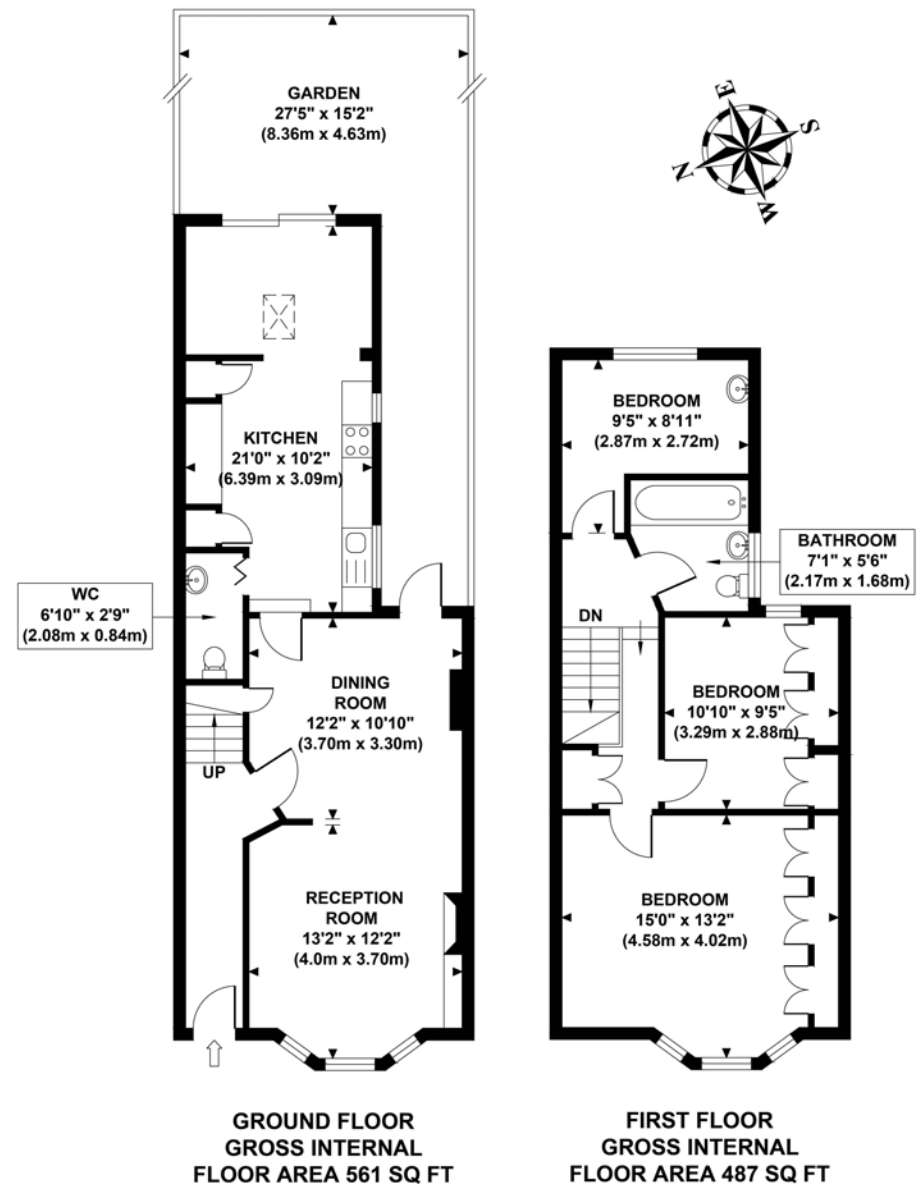

Although every attempt has been made to ensure accuracy, all measurements are approximate and no responsibility is taken for any error, omission, or mid-statement. This floor plan is for illustrative purposes only and not to scale. Measured in accordance to RICS standards. GB PRO PHOTOS

Your local independent
award winning estate agents



Northfields

130-132 Northfield Avenue,
Ealing W13 9RT
Sales: 020 8840 6666
E: nasales@northfields.co.uk

020 8840 6666

www.northfields.co.uk

CONTACT

Us today

TO FIND OUT

MORE