



Websters
estate agents

Norcutt Road, Twickenham, TW2 6SR

Mid Terrace 2 bedroom Victorian family home with a west facing courtyard garden in a popular, quiet cul-de-sac location. Situated just 0.3 miles from Twickenham Green, local shops, bars and restaurants and only 0.8 miles from Strawberry Hill and Twickenham mainline train station.

Immaculately presented and fully refurbished by the current owners to offer 657 sq ft of well balanced living space over 2 floors with high specification fixtures and fittings, wood flooring downstairs, double glazed sash style windows, energy efficient heating and lighting and pleasing neutral decor throughout.

Front door opens into the living room with access to the dining room and the kitchen at the rear. This light filled room has stylish fitted units and a door opening onto the low maintenance paved garden with rear gated access. On the first floor are 2 double bedrooms, the family bathroom and hatch access to loft storage.

Located within 0.5 miles of Archdeacon Primary, Trafalgar Primary and St Richard Reynolds Primary/Secondary Schools, 0.6 miles from Twickenham town centre and 0.7 miles from Church Street and Twickenham Riverside with a towpath walk along the Thames past Marble Hill Park to Richmond.

EPC Rating D

- Mid Terrace Victorian Home
- 2 Bedrooms and Upstairs Bathroom
- Low Maintenance Courtyard Garden
- Immaculately Presented
- 2 Living Rooms and Seperate Kitchen
- Popular Residential Location
- 0.3 Miles from Twickenham Green



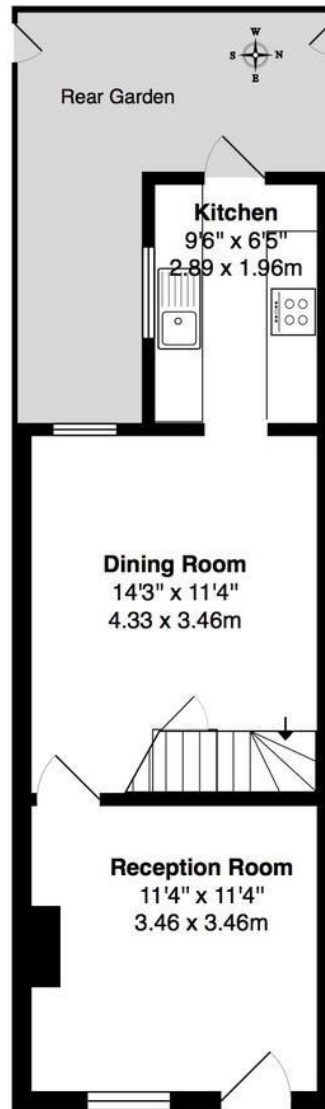

GROUND FLOOR

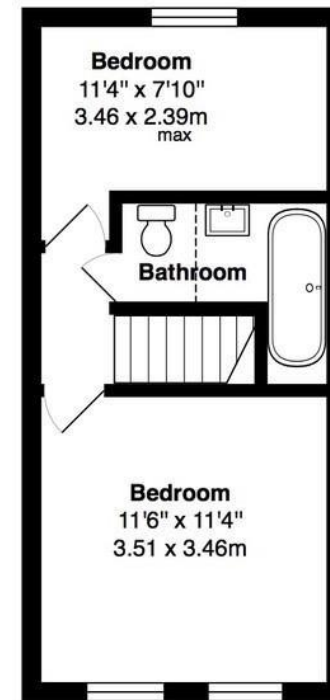

FIRST FLOOR

TOTAL FLOOR AREA approx.= 657 Sq.Feet (61 sq.metres)

a Websters Estate Agents 164 Heath Road, Twickenham, Middlesex TW1 4BN **t** 020 8892 3343 **e** sales@mywebsters.co.uk **w** mywebsters.co.uk

Disclaimer

These particulars, whilst believed to be accurate are set out as a general outline only for guidance and do not constitute any part of an offer or contract. Intending purchasers should not rely on them as statements of representation of fact, but must satisfy themselves by inspection or otherwise as to their accuracy. We have not carried out a detailed survey nor tested the services, appliances and specific fittings. Room sizes should not be relied upon for carpets and furnishings. The measurements given are approximate. No person in this firm's employment has the authority to make or give any representation or warranty in respect of the property.

