



Northfields

CAMBRIDGE ROAD
W7

£365,000

Hanwell



CAMBRIDGE ROAD, W7

£365,000



Reception Room



Kitchen



One Bedroom



Bathroom



On Street Parking

This modern bedroom apartment is set on the first floor and features bright & spacious open plan living areas, a double bedroom with fitted wardrobes, a stunning fully tiled bathroom and a private balcony.

Situated close to local shopping parade, transport links and the open spaces of Elthorne and Boston Parks.

EPC RATING: B

LOCAL AUTHORITY: London Borough of Ealing

COUNCIL TAX BAND: C

LENGTH OF LEASE: 125 years from and including 1 January 2015

You may wish to instruct us about a related service, including: the sale and letting of residential and commercial property, the provision of mortgage and financial services, conveyancing and property management. Where you choose to use other services, Northfields or its employees may receive a fee or commission which will be disclosed to you.

SAREN HOUSE

Approximate Gross Internal Area 635 sq ft / 59.0 sq m

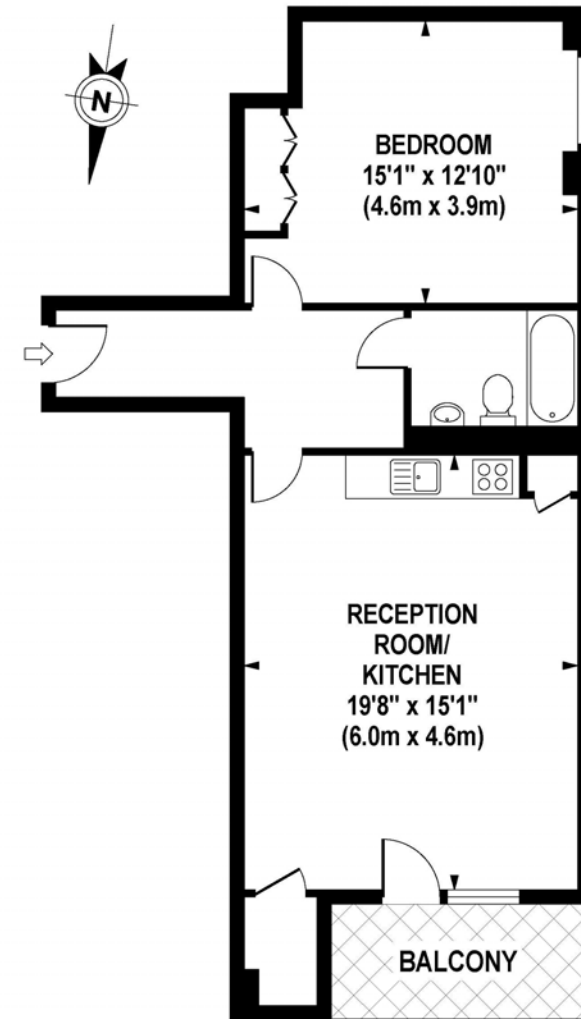

FIRST FLOOR
GROSS INTERNAL
FLOOR AREA 635 SQ FT

Although every attempt has been made to ensure accuracy, all measurements are approximate. The floor plan's for illustrative purposes only and not to scale. Measured in accordance to RICS standards.

DE-PHOTOGRAPHY.NET

Your local independent
award winning estate agents



Northfields

130-132 Northfield Avenue,
Ealing W13 9RT
Sales: 020 8840 6666
E: nasales@northfields.co.uk

020 8840 6666

www.northfields.co.uk

CONTACT

Us today

TO FIND OUT

MORE