



TUDOR COURT



**Websters**  
estate agents



# Park Road, Teddington, TW11 0AH

First Floor 1 double bedroom apartment in a popular modern development with communal gardens, residents parking and a private garage. Situated just 0.2 miles from Teddington town centre shops, bars and restaurants and just 0.1 mile from Teddington mainline train station.

With a Share of Freehold this well proportioned home offers 517 sq ft of light and airy living space with secure entry phone access, modern fixtures, fittings and flooring, built in storage, large double glazed windows and neutral decor.

Entrance hallway leads to the double bedroom with fitted wardrobes, the bathroom, the spacious living/dining room with a large feature window and the separate fitted kitchen.

Located 0.3 miles from Bushy Park and 0.8 miles from Teddington Lock, the River Thames and towpath walks to Hampton Court Palace and Richmond upon Thames.

## EPC Rating C

- First Floor 1 Bedroom Apartment
- Share of Freehold
- Popular Teddington Location
- Private Garage and Residents Parking
- Tastefully Presented 517 Sq Ft of Living Space
- Communal Gardens
- 0.1 Mile from Teddington Station



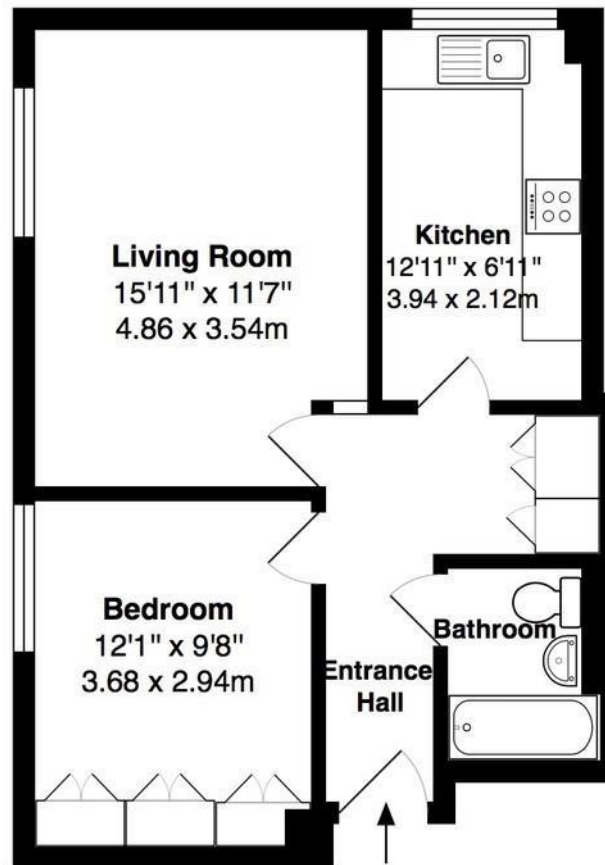

TOTAL FLOOR AREA approx.= 517 Sq.Feet (48 sq metres)

a Websters Estate Agents 36 Broad Street, Teddington, Middlesex TW11 8QY t 020 8614 6000 e sales@mywebsters.co.uk w mywebsters.co.uk

**Disclaimer**

These particulars, whilst believed to be accurate are set out as a general outline only for guidance and do not constitute any part of an offer or contract. Intending purchasers should not rely on them as statements of representation of fact, but must satisfy themselves by inspection or otherwise as to their accuracy. We have not carried out a detailed survey nor tested the services, appliances and specific fittings. Room sizes should not be relied upon for carpets and furnishings. The measurements given are approximate. No person in this firm's employment has the authority to make or give any representation or warranty in respect of the property.



