



Websters
estate agents

Rydal Gardens,Whitton,TW3 2HJ

A very appealing 3 bedroom semi-detached family home located in a popular, quiet cul-de-sac. The property has been extended on the ground floor creating a very useful full width family room connecting the kitchen and dining room onto the rear garden. Outside there is off street parking and a shared driveway leading to a carport and single garage. A real feature of the property is the 110 ft west facing mature garden.

- Semi Detached
- 3 Bedrooms
- Downstairs W.C
- Through Reception Room
- Rear Extension
- 110ft West Facing Garden
- Carport & Garage
- Modern Kitchen & Bathroom
- Quiet Cul-de-Sac Location



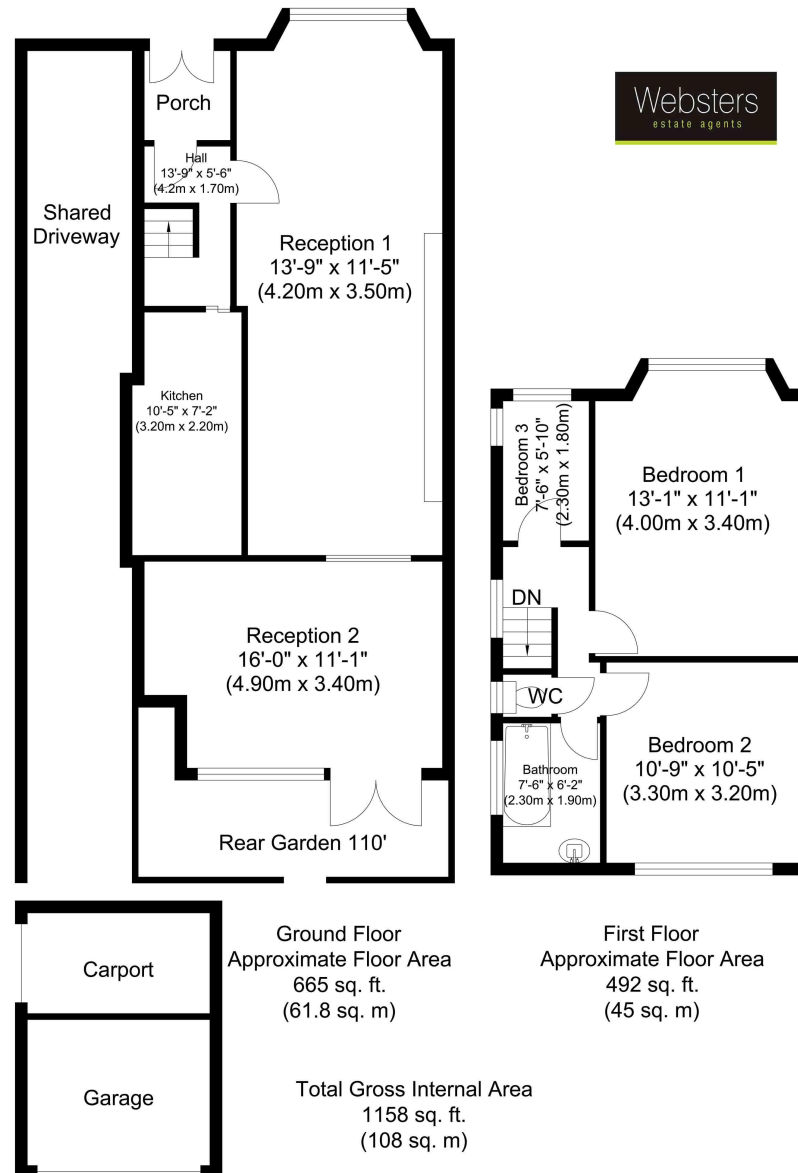

46 Rydal Gardens, Whitton

Whilst every attempt has been made to ensure the accuracy of the floor plan contained here, measurements of doors, windows, rooms and any other items are approximate and no responsibility is taken for any error, omission, or mis-statement. This plan is for illustrative purposes only and should be used as such by any prospective purchaser. The services, systems and appliances shown have not been tested and no guarantee as to their operability or efficiency can be given.
www.virtual360.net

a Websters Estate Agents 36 Broad Street, Teddington, Middlesex TW11 8QY

t 020 8614 6000

e sales@mywebsters.co.uk **w** mywebsters.co.uk

Disclaimer

These particulars, whilst believed to be accurate are set out as a general outline only for guidance and do not constitute any part of an offer or contract. Intending purchasers should not rely on them as statements of representation of fact, but must satisfy themselves by inspection or otherwise as to their accuracy. We have not carried out a detailed survey nor tested the services, appliances and specific fittings. Room sizes should not be relied upon for carpets and furnishings. The measurements given are approximate. No person in this firm's employment has the authority to make or give any representation or warranty in respect of the property.

