



VALETTA ROAD
W3

£500,000

Acton





VALETTA ROAD, W3

£500,000



Reception Room



Kitchen



Two Bedrooms



Bathroom



On Street

This two double bedroom maisonette will stand out not only because of its location in an area very much in demand, but because of the fusion of period charm with modern style. The bay window in the front bedroom allows light to stream in, throwing light over the wooden floors and creating a bright and inviting atmosphere. A second bedroom can be found further along the hall and the main bathroom is tucked into a corner to make the most of the space. The modern white suite includes a bathtub with a shower above. At the end of the hallway you'll find the reception room where double doors lead out onto the side garden. The separate fitted Kitchen is filled with light and lovely views over the garden.

Valetta Road is a short walk away from the shops and cafés along the Uxbridge and Askew roads, including trendy cafés like Brackenbury's Delicatessen and gastro-pub The Eagle. Added to that, the many bus links along the Uxbridge Road mean that the wide choice of shops, restaurants and leisure destinations of Westfield Shopping Centre are easy to reach. Central London is also well served by bus routes from this spot and Stamford Brook and Turnham Green stations can both be accessed from this area providing underground connections via the District line. The popular Wendell Park is close by and provides a community feel to the area and neighboring Chiswick is not far away offering a trendy mix of shops, restaurants and bars.

EPC RATING: D

LOCAL AUTHORITY: London Borough of Ealing

COUNCIL TAX BAND: D

LENGTH OF LEASE: 999 years from 25 March 2008

You may wish to instruct us about a related service, including: the sale and letting of residential and commercial property, the provision of mortgage and financial services, conveyancing and property management. Where you choose to use other services, Northfields or its employees may receive a fee or commission which will be disclosed to you.

VALETTA ROAD
Approximate Gross Internal Area
635 sq ft / 59.0 sq m

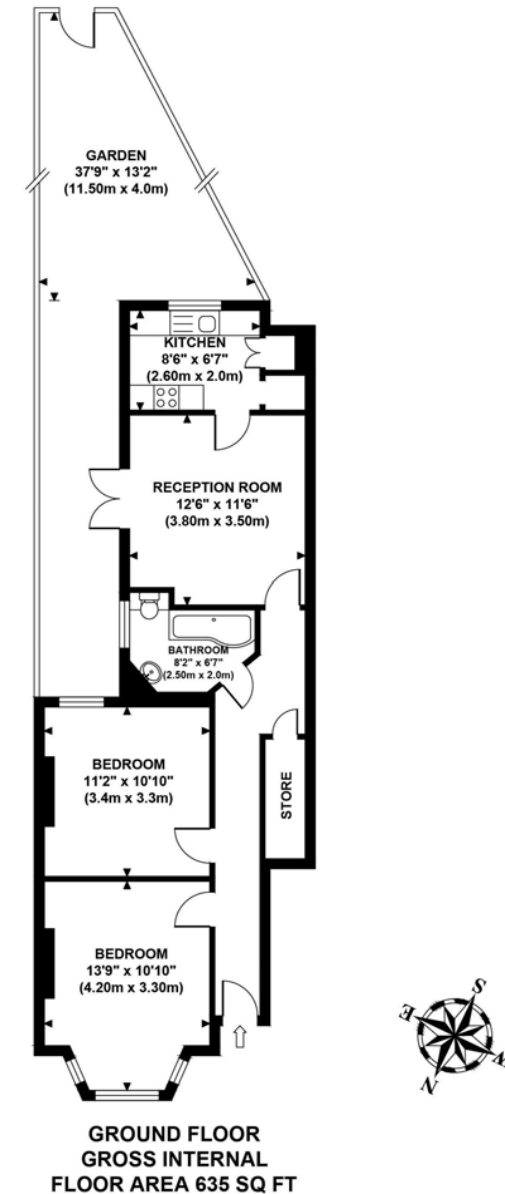

Although every attempt has been made to ensure accuracy, all measurements are approximate and no responsibility is taken for any error, omission, or mid-statement. This floor plan is for illustrative purposes only and not to scale. Measured in accordance to RICS standards.
GB PRO PHOTOS

Your local independent
award winning estate agents



Shepherds Bush

127 Askew Road,
Shepherds Bush W12 9AU
Sales: 020 8740 8833
E: sbsales@northfields.co.uk

020 8740 8833

www.northfields.co.uk

CONTACT

Us today

TO FIND OUT

MORE