



002

002

Websters  
estate agents



# Station Road, Twickenham, TW1 4LL

Raised Ground Floor 1 bedroom conversion apartment in a well maintained semi detached attractive period property with a 150 year Lease and no onward chain. Situated less than 0.2 miles from Twickenham Town Centre and mainline train station and 0.6 miles from the A316 with direct access to the M3/M25 and into central London.

In need of updating and offering potential to create a stunning home with 469 sq ft of well balanced living space, charming period features, high ceilings, large sash windows and built in storage.

Front door opens into the hallway with storage and access to the double bedroom, the bathroom, the living room and the separate fitted kitchen.

Located 0.4 miles from Church Street shops, bars and restaurants and Twickenham Riverside with a beautiful towpath walk past Orleans House and Marble Hill Park to Richmond upon Thames.

EPC Rating D

- Raised Ground Floor 1 Bedroom Apartment
- No Onward Chain
- In Need of Updating
- 150 Years Remaining on Lease
- Charming Period Features
- Well Balanced 469 Sq Ft of Living Space
- 0.2 Miles from Twickenham Station



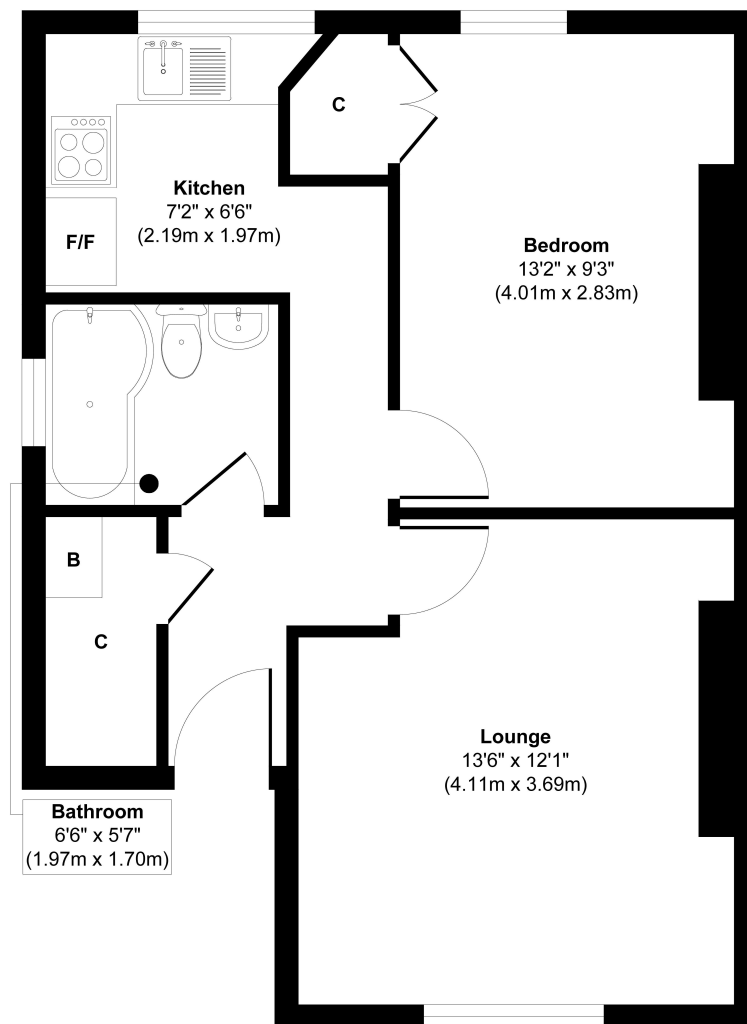

**Floor Plan**  
**Approximate Floor Area**  
**469 sq. ft**  
**(43.60 sq. m)**

Approx. Gross Internal Floor Area 469 sq. ft / 43.60 sq. m

**a** Websters Estate Agents 36 Broad Street, Teddington, Middlesex TW11 8QY    **t** 020 8614 6000    **e** sales@mywebsters.co.uk    **w** mywebsters.co.uk

**Disclaimer**  
 These particulars, whilst believed to be accurate are set out as a general outline only for guidance and do not constitute any part of an offer or contract. Intending purchasers should not rely on them as statements of representation of fact, but must satisfy themselves by inspection or otherwise as to their accuracy. We have not carried out a detailed survey nor tested the services, appliances and specific fittings. Room sizes should not be relied upon for carpets and furnishings. The measurements given are approximate. No person in this firm's employment has the authority to make or give any representation or warranty in respect of the property.

