



Websters
estate agents

Shaef Way, Teddington, TW11 0DG

Ground Floor 2 bedroom Maisonette with private front, side and rear gardens, a garage in a separate block, 935 year Lease and no service charge. Located in Shaef Way directly opposite Bushy Park only 0.1 mile from the access gate just 0.6 miles from Teddington town centre shops, cafes and restaurants and 0.4 miles from Teddington train station.

With no onward chain, in need of some updating and offering 743 sq ft of well proportioned living space with large double glazed windows and doors, neutral decor throughout and built in storage

Front door at the side of the property leads to the spacious hallway with doors to the 2 bedrooms at the rear, the shower room, separate w.c, the living room and the dual aspect kitchen.

Situated within 0.8 miles of Collis, Sacred Heart and St Marys & St Peters Primary Schools. EPC Rating F

- Ground Floor 2 Bedroom Maisonette
- Front, Side and Rear Garden
- No Onward Chain
- 934 Year Lease and No Service Charge
- Garage in Separate Block
- Just 0.1 Mile from Bushy Park Gate
- 0.6 Miles from Teddington Station



Shaef Way, TW11

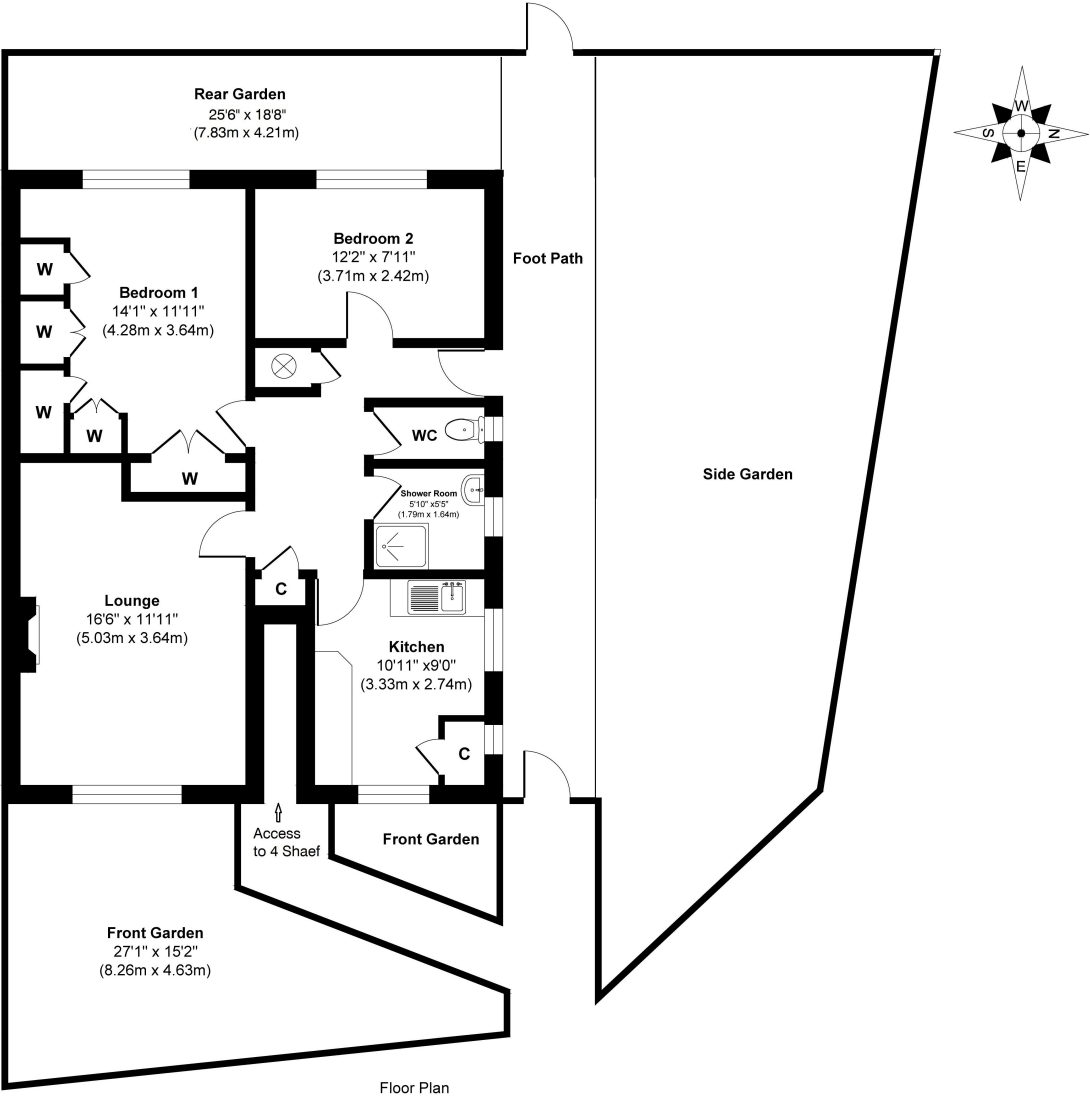

Approx. Gross Internal Floor Area 743 sq. ft / 69.04 sq. m

[a](#) Websters Estate Agents 36 Broad Street, Teddington, Middlesex TW11 8QY [t](#) 020 8614 6000 [e](#) sales@mywebsters.co.uk [w](#) mywebsters.co.uk

Disclaimer
These particulars, whilst believed to be accurate are set out as a general outline only for guidance and do not constitute any part of an offer or contract. Intending purchasers should not rely on them as statements of representation of fact, but must satisfy themselves by inspection or otherwise as to their accuracy. We have not carried out a detailed survey nor tested the services, appliances and specific fittings. Room sizes should not be relied upon for carpets and furnishings. The measurements given are approxiamte. No person in this firms employment has the authority to make or give any representation or warranty in respect of the property.

