



02

104

05
889

108

Websters
estate agents
CALLING ALL
PROPERTY OWNERS
FOR SALE

Websters
estate agents

Third Cross Road, Twickenham, TW2 5EA

First Floor purpose built maisonette with a private south west facing garden and a Share of Freehold. Situated in a highly regarded location 0.2 miles from Twickenham Green, local shops, cafes, restaurants and bus stops and only 0.6 miles from Strawberry Hill village and train station.

Immaculately presented to offer 630sq ft of well balanced living space with modern fixtures, fittings and floorings, double glazed windows, built in storage, pleasing neutral decor throughout and potential to loft convert (subject to Planning Permission and Building Regulations)

Private front door leads upstairs to the hallway with doors to the bay fronted living room, the main bedroom, the study/bed 2 and the kitchen at the rear. This spacious room has a large window, stylish fitted kitchen units, space for dining and access to the bathroom. Steps lead down to the sun room and the laundry cupboard. Doors open onto the paved low maintenance garden with gated rear access

Located less than 1 mile from Twickenham town centre, mainline train station and the A316 with direct access to the M3/M25 and into central London.
EPC Rating D

- First Floor 2 Bedroom Maisonette
- South West Facing Garden with Sun Room
- Share of Freehold
- High Specification Throughout
- Potential to Loft Convert (stpp)
- Living Room and Kitchen/Dining Room
- 0.6 Miles from Strawberry Hill Station
- 0.2 Miles from Twickenham Green



Third Cross Road, TW2

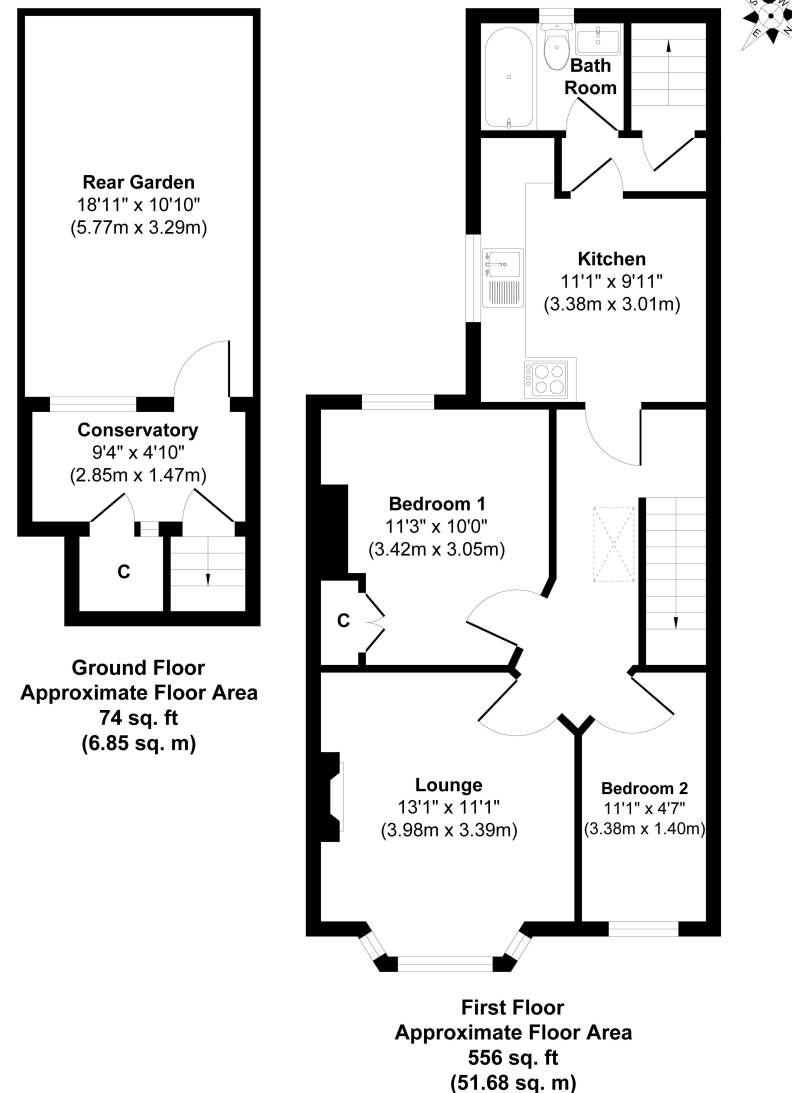

Approx. Gross Internal Floor Area 630 sq. ft / 58.53 sq. m

a Websters Estate Agents 36 Broad Street, Teddington, Middlesex TW11 8QY

t 020 8614 6000

e sales@mywebsters.co.uk w mywebsters.co.uk

Disclaimer

These particulars, whilst believed to be accurate are set out as a general outline only for guidance and do not constitute any part of an offer or contract. Intending purchasers should not rely on them as statements of representation of fact, but must satisfy themselves by inspection or otherwise as to their accuracy. We have not carried out a detailed survey nor tested the services, appliances and specific fittings. Room sizes should not be relied upon for carpets and furnishings. The measurements given are approximate. No person in this firm's employment has the authority to make or give any representation or warranty in respect of the property.

