



Websters
estate agents

Walpole Road, Teddington, TW11 8TG

Ground Floor 2 bedroom apartment in a popular over 60's Independent Living/Retirement development with a private patio. Situated in central Teddington with direct access to shops, cafes, restaurants, bus stops towards Kingston, Richmond and Heathrow and just 0.4 miles from Teddington train station.

With a 70% share of ownership and no onward chain or monthly rental. Tastefully presented, in need of some updating and offering 549 sq ft of living space with secure entry phone access, communal gardens and courtyard, some residents parking, an on-site manager, laundry room, residents lounge and use of the family guest suite.

Entrance hallway leads to the 2 bedrooms, the bathroom, the living/dining room with doors onto the patio and communal gardens and the separate fitted kitchen.

Located less than 0.6 miles from Bushy Park and 0.9 miles from Teddington footbridge leading across the Thames to Teddington Lock, Ham Lands and towpath walks towards Richmond and Hampton Court Palace.

EPC Rating C

- Ground Floor 2 Bedroom Apartment
- Over 60's Independent Living
- Private Patio and Communal Gardens
- No Onward Chain
- Central Teddington Location
- On Site Manager and Residents Lounge
- 0.4 Miles from Teddington Station
- Some Residents Parking



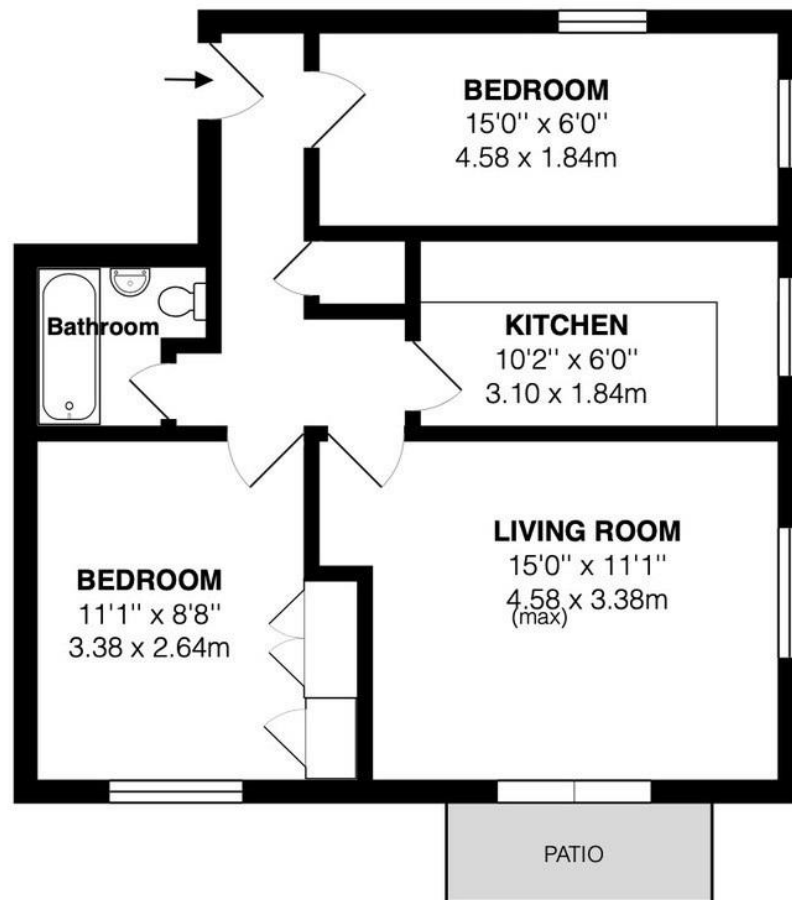

TOTAL FLOOR AREA approx.= 549 Sq.Feet (51 sq metres)

Disclaimer

These particulars, whilst believed to be accurate are set out as a general outline only for guidance and do not constitute any part of an offer or contract. Intending purchasers should not rely on them as statements of representation of fact, but must satisfy themselves by inspection or otherwise as to their accuracy. We have not carried out a detailed survey nor tested the services, appliances and specific fittings. Room sizes should not be relied upon for carpets and furnishings. The measurements given are approximate. No person in this firm's employment has the authority to make or give any representation or warranty in respect of the property.

