



Websters
estate agents
020 8544 6000
mywebsters.co.uk
For Sale

24

Websters
estate agents

LF60 YFJ

Shacklegate Lane, Teddington, TW11 8SH

End of Terrace 2 double bedroom Victorian family home in a popular residential area with a private south facing rear garden. Situated 0.1 mile from local shops, 0.4 miles from Fulwell train station and 0.8 miles from Teddington mainline train station.

With vacant possession, no chain and in need of some modernisation. Well maintained with modern fixtures and fittings, double glazed windows and charming period features to offer 775 sq ft of living space over 2 floors. Potential to loft convert, extend and reconfigure the layout to create a bespoke family home (subject to Planning Permission and Building Regulations)

Entrance porch opens into the bay fronted living room with access to the dining room and fitted kitchen at the rear. A door opens onto the currently overgrown 35ft garden with a lawn, mature planting, shed storage and secure gated side access. On the first floor are 2 double bedrooms, the family bathroom and hatch access to the loft.

Located less than 0.4 miles from St Mary's and St Peter's Primary and Stanley Primary, 0.6 miles from St James Primary and Waldegrave Girls School/Sixth Form and just 0.5 miles from Teddington High Street shops, bars and restaurants and only 0.7 miles from Bushy Park. EPC Rating D

- End Of Terrace Victorian Home
- Vacant Possession and No Chain
- 2 Double Bedrooms and Upstairs Bathroom
- Potential to Extend and Loft Convert (stpp)
- South Facing Garden
- 2 Living Rooms and Separate Kitchen
- 0.5 Miles from Teddington Town Centre



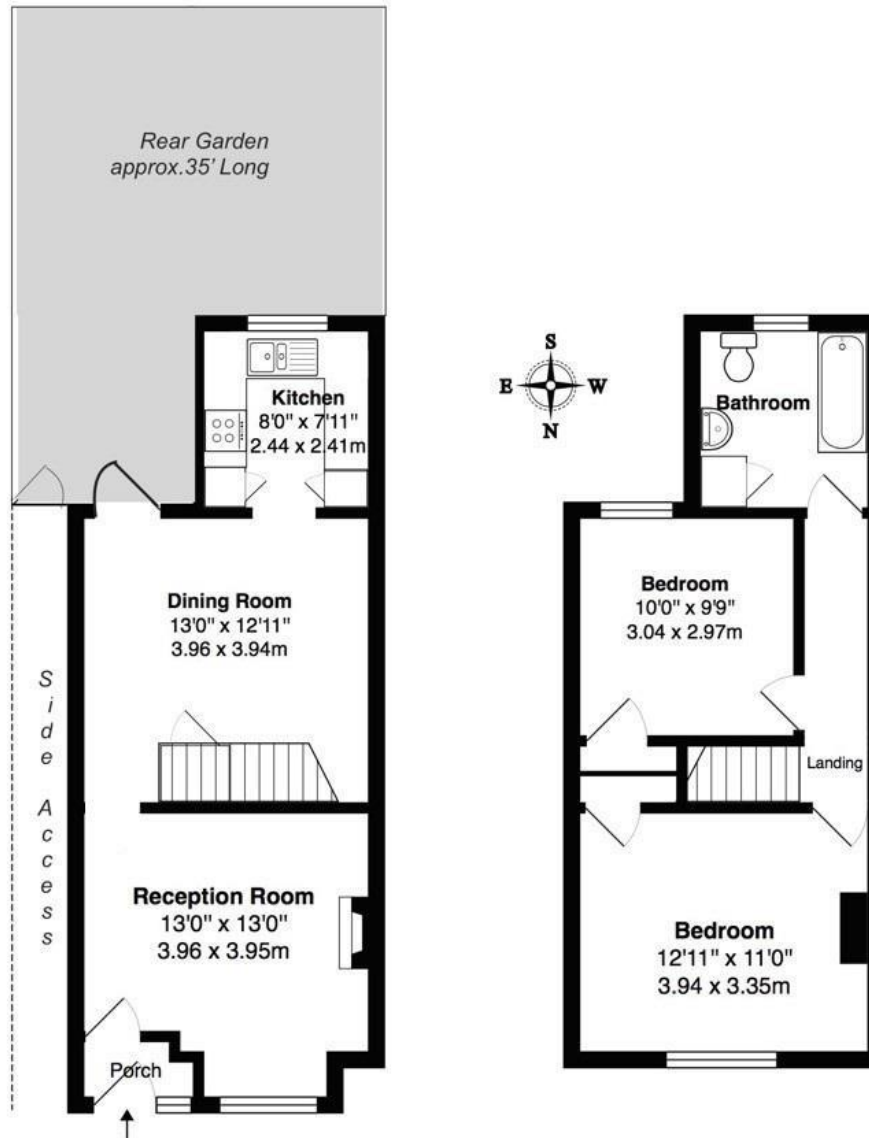

TOTAL FLOOR AREA approx.= 775 Sq.Feet (72 sq.metres)

a Websters Estate Agents 36 Broad Street, Teddington, Middlesex TW11 8QY t 020 8614 6000 e sales@mywebsters.co.uk w mywebsters.co.uk

Disclaimer
 These particulars, whilst believed to be accurate are set out as a general outline only for guidance and do not constitute any part of an offer or contract. Intending purchasers should not rely on them as statements of representation of fact, but must satisfy themselves by inspection or otherwise as to their accuracy. We have not carried out a detailed survey nor tested the services, appliances and specific fittings. Room sizes should not be relied upon for carpets and furnishings. The measurements given are approximate. No person in this firm's employment has the authority to make or give any representation or warranty in respect of the property.

