



Websters
estate agents

Field Lane, Teddington, TW11 9BA

First Floor 2 bedroom apartment in a popular over 60's Independent Living/Retirement development with a private balcony. Situated in central Teddington with direct access to shops, cafes, restaurants, bus stops towards Kingston, Richmond and Heathrow and just 0.3 miles from Teddington train station.

With a 70% share of ownership, no chain or monthly rental.

Tastefully presented to offer 561 sq ft of living space with entry phone access, lifts to all floors, communal gardens, some residents parking, a full time on-site manager, residents laundry room and use of the family guest suite.

Hallway leads to the 2 bedrooms, the walk in shower room, the spacious living room with a private decked balcony and the separate recently fitted kitchen.

Located less than 0.5 miles from Bushy Park and Teddington footbridge leading across the Thames to Teddington Lock, Ham Lands and towpath walks towards Richmond and Hampton Court Palace.

EPC Rating C

- First Floor 2 Bedroom Apartment
- Over 60's Independent Living
- Private Balcony and Communal Gardens
- No Onward Chain
- Central Teddington Location
- Full Time On Site Manager
- 0.3 Miles from Teddington Station



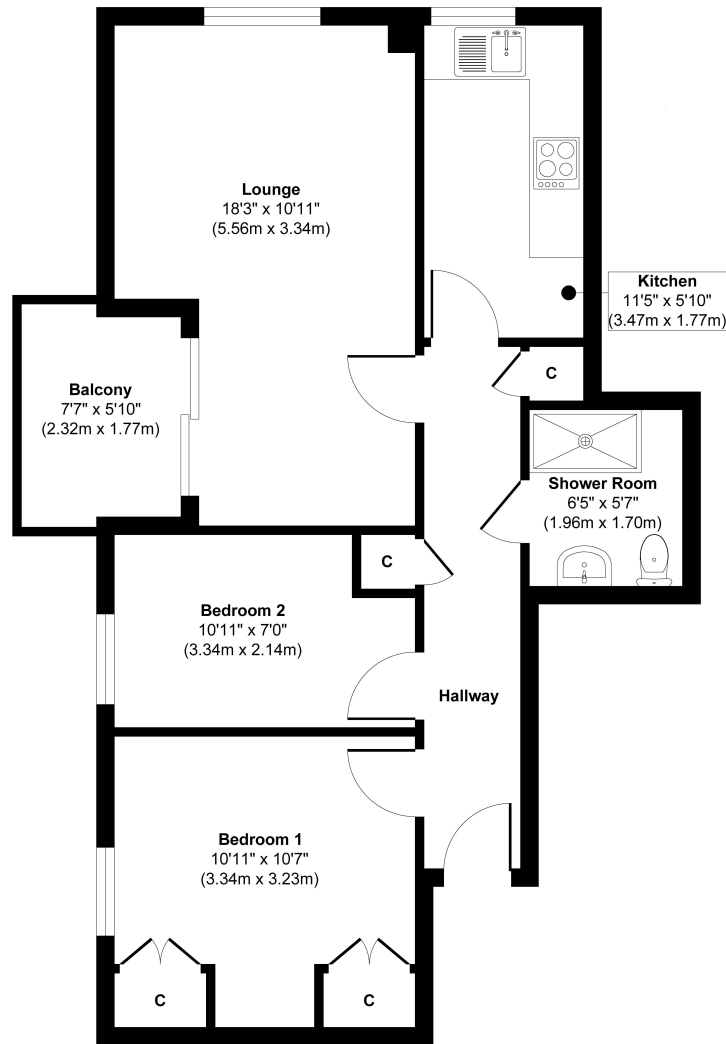

Approx. Gross Internal Floor Area 561 sq. ft / 52.19 sq. m

Illustration for identification purposes only, measurements are approximate, not to scale.
Produced by Elements Property

a Websters Estate Agents 36 Broad Street, Teddington, Middlesex TW11 8QY

t 020 8614 6000

e sales@mywebsters.co.uk **w** mywebsters.co.uk

Disclaimer

These particulars, whilst believed to be accurate are set out as a general outline only for guidance and do not constitute any part of an offer or contract. Intending purchasers should not rely on them as statements of representation of fact, but must satisfy themselves by inspection or otherwise as to their accuracy. We have not carried out a detailed survey nor tested the services, appliances and specific fittings. Room sizes should not be relied upon for carpets and furnishings. The measurements given are approximate. No person in this firm's employment has the authority to make or give any representation or warranty in respect of the property.

