



Chase  
Buchanan  
-success-  
0202 6744 1115

Websters  
estate agents  
0202 6744 1115  
www.websters.co.uk

Websters  
estate agents



# Albion Road, Twickenham, TW2 6QJ

Mid Terrace 2 bedroom Victorian home with a southerly aspect garden and a purpose built home office. Situated in a popular residential area less than 100 metres from Twickenham Green, local shops, cafes and restaurants.

Tastefully presented to offer 750 sq ft of well proportioned living space over 2 floors with modern fixtures and fittings, charming period features, sash windows with shutters at the front, neutral decor throughout and a fully useable 111 sq ft converted loft room.

Front door opens into the living room with wood flooring, a feature fireplace, built in storage and access to the separate dining room. A door opens to the kitchen/breakfast room with stylish fitted units, space for dining and a part glazed roof. Double doors open onto the low maintenance garden with a purpose built home office/gym and storage. On the first floor are 2 bedrooms and the family bathroom. A pull down ladder provides access to the loft room which is boarded and decorated with a feature brick wall, roof window, power and lighting and is ideal for storage or use as a study/hobby/occasional room.

Located 0.6 miles from Strawberry Hill Station and Twickenham town centre and just 0.8 miles from Twickenham mainline station.  
EPC Rating C

- Mid Terrace Victorian Family Home
- 2 Bedrooms and Upstairs Bathroom
- 111Sq Ft Loft/Hobby Room
- South Facing Garden with Home Office
- 2 Living Rooms and Kitchen/Breakfast Room
- 0.6 Miles from Strawberry Hill Station
- Less than 100 Metres from Twickenham Green



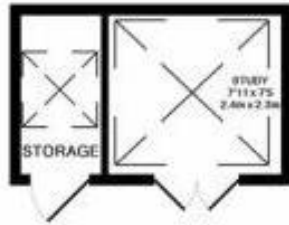

**ALBION ROAD**  
 TOTAL APPROX FLOOR AREA  
 750 Sq Ft (69.6 Sq M)  
 861 Sq Ft (80.0 Sq M) including Loft Room



GROUND FLOOR  
 APPROX. FLOOR  
 AREA 489 SQ.FT.  
 (45.4 SQ.M.)



1ST FLOOR  
 APPROX. FLOOR  
 AREA 261 SQ.FT.  
 (24.3 SQ.M.)

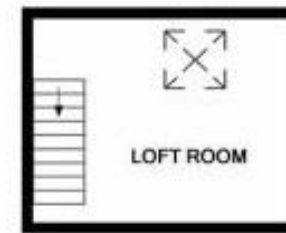

2ND FLOOR  
 APPROX. FLOOR  
 AREA 111 SQ.FT.  
 (10.3 SQ.M.)

**a** Websters Estate Agents 36 Broad Street, Teddington, Middlesex TW11 8QY **t** 020 8614 6000 **e** sales@mywebsters.co.uk **w** mywebsters.co.uk

**Disclaimer**

These particulars, whilst believed to be accurate are set out as a general outline only for guidance and do not constitute any part of an offer or contract. Intending purchasers should not rely on them as statements of representation of fact, but must satisfy themselves by inspection or otherwise as to their accuracy. We have not carried out a detailed survey nor tested the services, appliances and specific fittings. Room sizes should not be relied upon for carpets and furnishings. The measurements given are approximate. No person in this firm's employment has the authority to make or give any representation or warranty in respect of the property.



