



Yale

13

Websters
estate agents

Hospital Bridge Road, Twickenham, TW2 5UL

Semi Detached 5 bedroom family home with driveway parking for 2/3 cars, a southwest facing garden and shared vehicular access to the garage at the rear. Situated 150 metres from Crane Park with a towpath walk/cycle track along the River Crane and less than 0.7 miles from Trafalgar, Heathfield and Bishop Perrin Primary Schools and Waldegrave Girls School/Co-ed Sixth Form.

Extended and loft converted to offer an impressive 1501 sq ft of tastefully presented living space over 3 floors with high specification fixtures, fittings and floorings, double glazed windows and doors and modern decor throughout.

Entrance hallway leads to the dual aspect, open plan living area. This spacious room has a wood flooring, a feature fireplace, living area at the front, space for dining and a stylish fitted kitchen with a breakfast bar at the rear. Double doors open onto the garden with large patio areas, lawn, a door into the garage and secure gated rear access to the vehicular access track. On the first floor are 3 bedrooms, the master with built in wardrobes and an en-suite shower room and the family bathroom. Stairs lead up to 2 further bedrooms, the shower room and the dressing room/study area.

Located 0.2 miles from the A316 with direct access to the M3/M25 and into central London and 0.8 miles from Whitton town centre shops, bars restaurants and the mainline train station. EPC Rating D

- Semi Detached 5 Bedroom Home
- Driveway Parking, Garage and Southwest Facing Garden
- Extended and Loft Converted
- 1501 Sq Ft of Well Proportioned Living Space
- Open Plan Family Living Space
- Tastefully Presented Throughout
- Within 0.7 Miles of Numerous Popular Schools





SECOND FLOOR

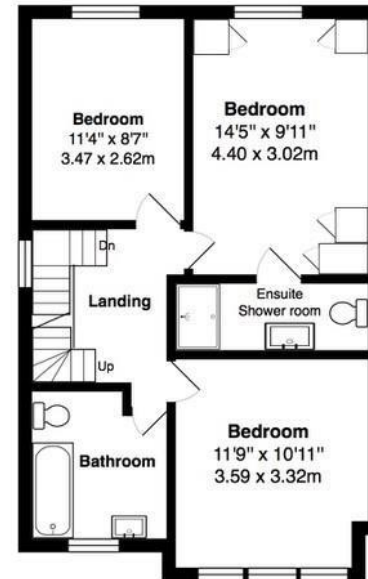
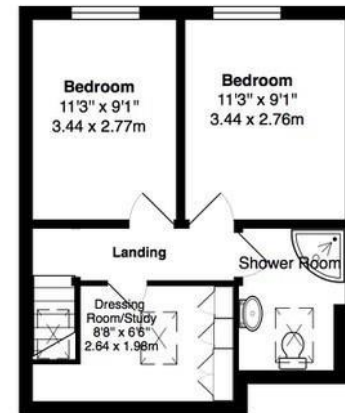

FIRST FLOOR

TOTAL FLOOR AREA approx. = 1,501 Sq. Feet
(139.43 sq. metres)

a Websters Estate Agents 164 Heath Road, Twickenham, Middlesex TW1 4BN t 020 8892 3343 e sales@mywebsters.co.uk w mywebsters.co.uk

Disclaimer
These particulars, whilst believed to be accurate are set out as a general outline only for guidance and do not constitute any part of an offer or contract. Intending purchasers should not rely on them as statements of representation of fact, but must satisfy themselves by inspection or otherwise as to their accuracy. We have not carried out a detailed survey nor tested the services, appliances and specific fittings. Room sizes should not be relied upon for carpets and furnishings. The measurements given are approximate. No person in this firm's employment has the authority to make or give any representation or warranty in respect of the property.

