



Websters  
estate agents  
020 8614 6000  
mywebsters.co.uk For Sale

Websters  
estate agents



# Field Lane, Teddington, TW11 9AS

Mid Terrace 2 double bedroom Victorian family home in a popular central Teddington location with a west facing garden. Situated just 0.1 mile from High Street shops, bars and restaurants, 0.3 miles from Teddington train station and only 0.4 miles from Bushy Park.

Extended and refurbished to offer 773 sq ft of living space over 2 floors with high specification fixtures, fittings and floorings, sash style double glazed windows and doors and pleasing neutral decor throughout.

Front door opens into the living room with hallway access to the bathroom and the kitchen/family room at the rear. This light filled room has a stylish fitted kitchen, wood flooring, velux roof windows and space for dining and seating. Large double doors open onto low maintenance paved rear garden with storage. On the first floor are 2 double bedrooms.

Located 0.4 miles from Collis Primary, less than 0.7 miles from Sacred Heart and St Mary's & St Peter's Primary Schools and 0.5 miles from Teddington Footbridge across the Thames to the Lock, Ham Lands and towpath walks towards Hampton Court Palace and Richmond. EPC Rating D

- Mid Terrace Victorian Home
- 2 Double Bedrooms
- West Facing Garden
- Central Teddington Location
- High Specification Throughout
- 0.1 Mile from High Street Shops
- 0.3 Miles from Teddington Station

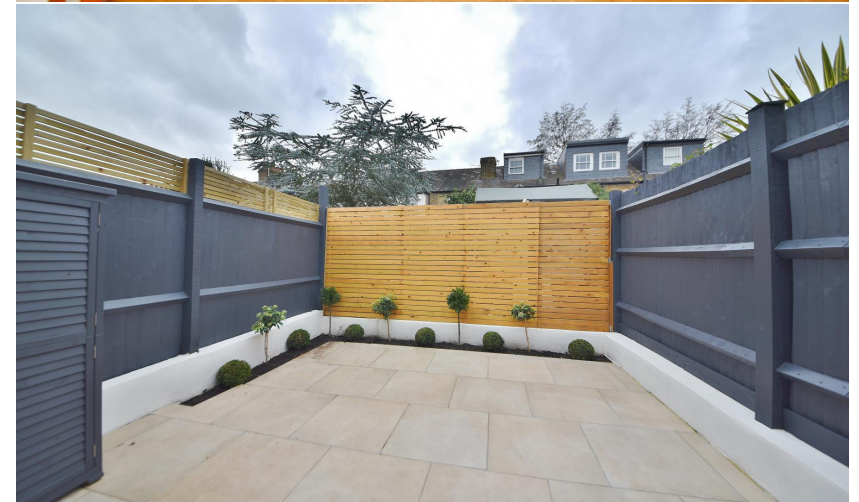

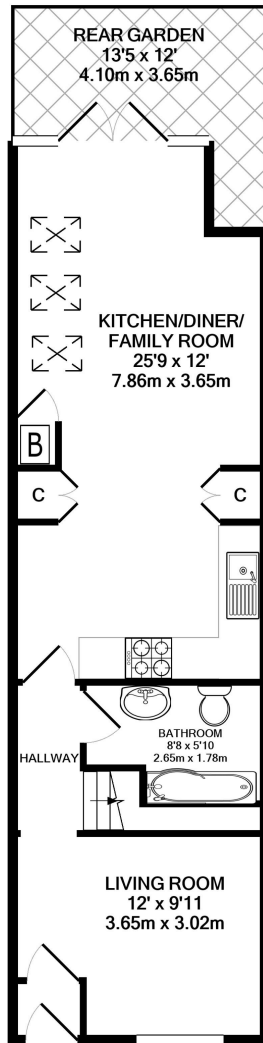

GROUND FLOOR  
APPROX. FLOOR  
AREA 500 SQ.FT.  
(46.5 SQ.M.)

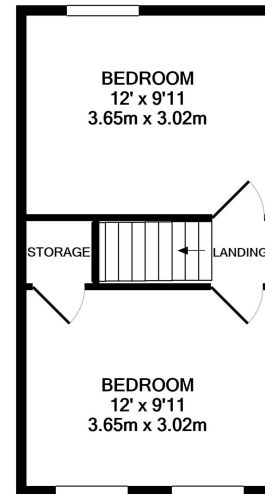

1ST FLOOR  
APPROX. FLOOR  
AREA 273 SQ.FT.  
(25.4 SQ.M.)

TOTAL APPROX. FLOOR AREA 773 SQ.FT. (71.9 SQ.M.)

Disclaimer

These particulars, whilst believed to be accurate are set out as a general outline only for guidance and do not constitute any part of an offer or contract. Intending purchasers should not rely on them as statements of representation of fact, but must satisfy themselves by inspection or otherwise as to their accuracy. We have not carried out a detailed survey nor tested the services, appliances and specific fittings. Room sizes should not be relied upon for carpets and furnishings. The measurements given are approximate. No person in this firm's employment has the authority to make or give any representation or warranty in respect of the property.

