



Englefield Green, Surrey

£3,750 Per calendar month

BUCKINGHAMS



A spacious townhouse located in a popular gated development in Englefield Green. This property offers excellent access to ACS Egham, Windsor Great Park, and Virginia Water train station. Double garage and rear garden with decking. EPC:C76.

Fees for tenants: Holding fee equivalent to one weeks rent, amendments to Tenancy Agreement after the document has been signed £50, change of sharer £50, stamp duty land tax (if total rent exceeds £125,000), 3% above the base rate of Bank of England per annum (calculated daily) for late/unpaid/returned rent payments, lost/damaged/broken keys/fobs or security devices at cost, deposit of five weeks rent if annual rent is less than £50,000 or six weeks rent if annual rent is £50,000 or more, all including VAT.

Approximate Gross Internal Area (inc. garage) - 230 sq m / 2474 sq ft

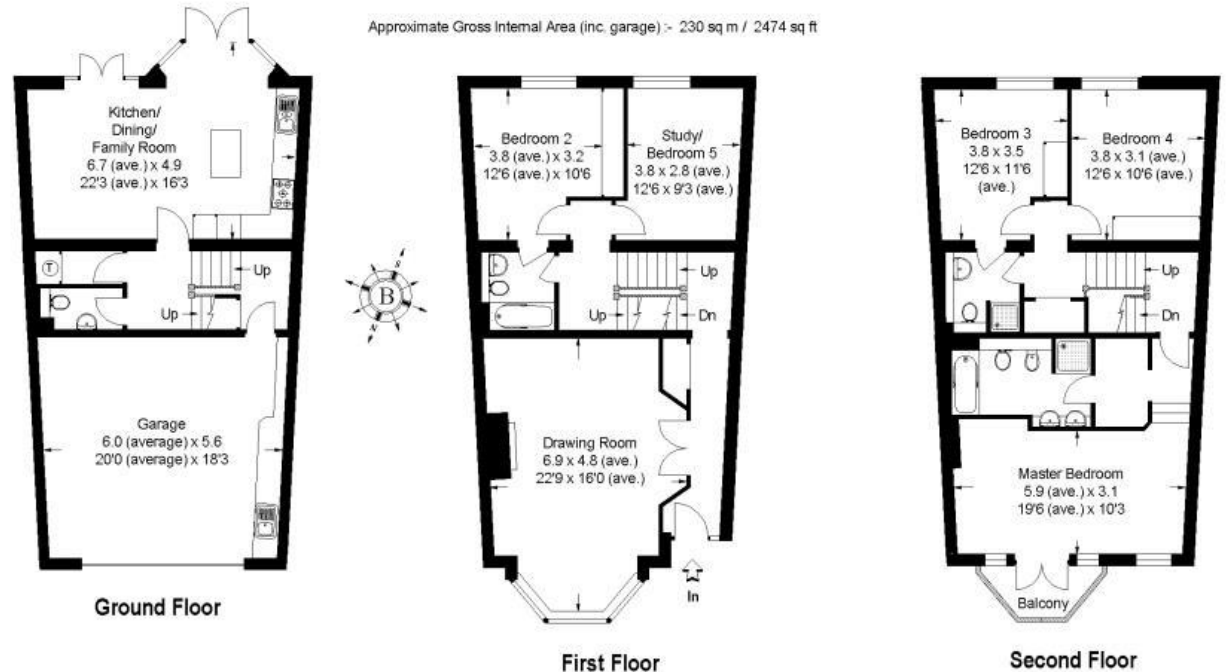

FLOOR PLANS © 2006
01483 755510 Ref 12860/ZS

This illustration is for identification purposes only. Measures & drawn in accordance with RICS / PMA guidelines. Not drawn to scale, unless stated. Dimensions shown are to the nearest 7.5 cm / 3" and are through cupboard / wardrobes to wall surfaces where possible or where indicated by arrow heads. Whilst every care is taken in the preparation of this plan, please check all dimensions shapes & compass bearings before making any decisions reliant upon them.

6 Station Approach Virginia Water Surrey GU25 4DL
01344 845050
www.buckinghamams.com
lettings@buckinghamams.com



BUCKINGHAMAMS