



Websters
estate agents
020 8882 3343
mywebsters.co.uk

Websters
estate agents

Lincoln Avenue, Twickenham, TW2 6NL

Mid Terrace 3 bedroom family home in a popular residential area with driveway parking and south facing garden backing onto Crane Park. Situated just 0.1 miles from access to Crane Park and Kneller Gardens, 0.7 miles from Twickenham Green, less than 0.6 miles of Trafalgar Primary and Waldegrave Girls School/Co-ed Sixth Form and 0.8 miles from Archdeacon Primary.

With no onward chain, in need of some updating and currently offering 1055 sq ft of living space over 3 floors with potential to extend, reconfigure the layout and fully loft convert (subject to Planning Permission and Building Regulations)

Entrance hallway leads to the open plan living/dining room and kitchen at the rear. A door leads to the conservatory with a w.c and access to the garden with mature planting, shed storage and a gated rear access. On the first floor are 2 bedrooms, the family bathroom and a wooden staircase leading to the loft room/bedroom 3.

Located 0.2 miles from the A316 with direct access to the M3/M25 and into central London and just 0.6 miles from Whitton town centre and mainline train station.
EPC Rating D

- Mid Terrace 3 Bedroom Family Home
- Garden Backing onto Crane Park
- No Onward Chain
- Potential to Extend, Reconfigure and Loft Convert (stpp)
- Currently 1055 Sq Ft over 3 Floors
- Driveway Parking
- Within 0.8 Miles of Popular Schools



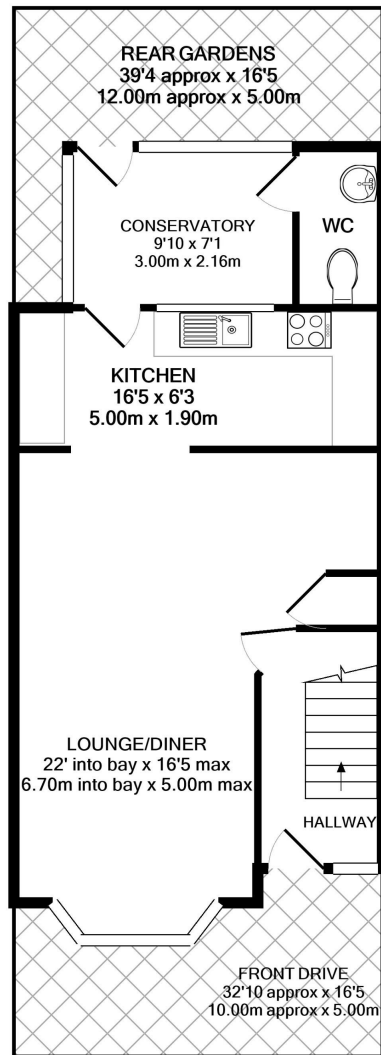

GROUND FLOOR
APPROX. FLOOR
AREA 524 SQ.FT.
(48.7 SQ.M.)

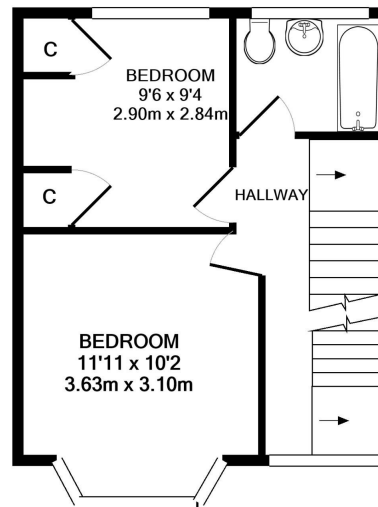

1ST FLOOR
APPROX. FLOOR
AREA 331 SQ.FT.
(30.7 SQ.M.)

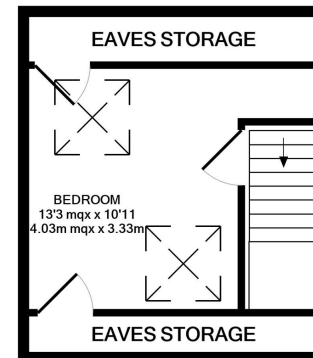

2ND FLOOR
APPROX. FLOOR
AREA 201 SQ.FT.
(18.7 SQ.M.)

TOTAL APPROX. FLOOR AREA 1055 SQ.FT. (98.1 SQ.M.)

a Websters Estate Agents 36 Broad Street, Teddington, Middlesex TW11 8QY

t 020 8614 6000

e sales@mywebsters.co.uk **w** mywebsters.co.uk

Disclaimer

These particulars, whilst believed to be accurate are set out as a general outline only for guidance and do not constitute any part of an offer or contract. Intending purchasers should not rely on them as statements of representation of fact, but must satisfy themselves by inspection or otherwise as to their accuracy. We have not carried out a detailed survey nor tested the services, appliances and specific fittings. Room sizes should not be relied upon for carpets and furnishings. The measurements given are approxiamte. No person in this firms employment has the authority to make or give any representation or warranty in respect of the property.

