



Websters
estate agents

020 8892 3343
mywebsters.co.uk

For Sale

Websters
estate agents

Arlington Close, East Twickenham, TW1 2BE

Detached 2 bedroom Bungalow on a 55ft wide x 180ft triangular plot with a garage, driveway parking and rear/side gardens. Situated just 0.4 miles from St Margarets village and train station and within 0.7 miles of Richmond Green, town centre shops, cafes and restaurants.

With no onward chain, in need of updating and offering 888 sq ft of adaptable well proportioned living space on the ground floor with large double glazed windows and doors, access to the gardens from 2 rooms and potential to refurbish, reconfigure the layout and create a stunning home.

Entrance hallway leads to the study, the large dual aspect living room with space for seating and dining, the separate fitted kitchen, the family bathroom and the 2 bedrooms both with built in wardrobes and one with an en-suite shower room. Doors in a bedroom and the living room open onto the mature rear gardens with side access to the large garage, driveway and the front garden area.

Located at the end of a cul-de-sac with no adjacent neighbours and only 0.1 miles from Thames riverside Ducks Walk and just 0.5 miles from Richmond Lock/weir and Old Deer Park.

EPC Rating F

- Detached 2 Bedroom Bungalow
- No Onward Chain and In Need of Updating
- Driveway, Garage and Side/Rear Gardens
- On a 55ft x 180ft Triangular Plot
- 888 Sq Ft of Adaptable Living Space
- 0.7 Miles from Richmond Town Centre
- 0.4 Miles from St Margarets Village and Station

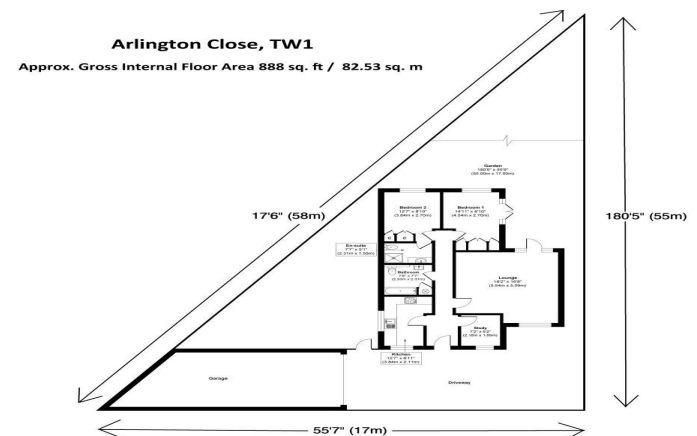

Arlington Close, TW1

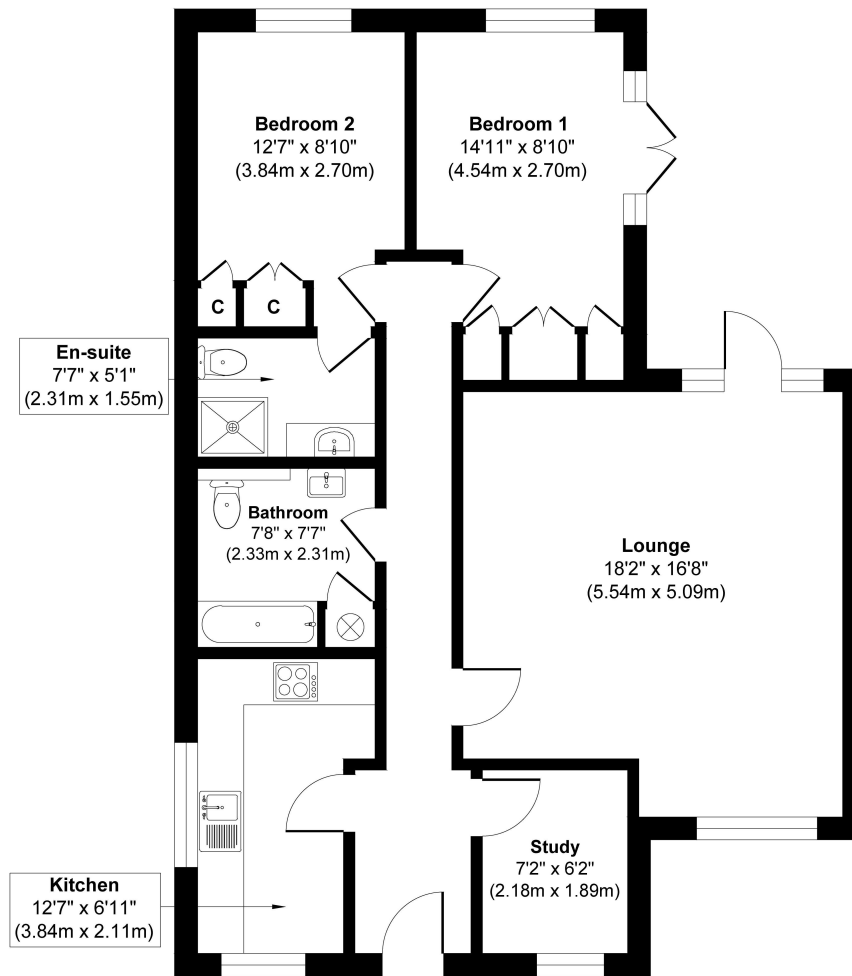

Floor Plan

Approx. Gross Internal Floor Area 888 sq. ft / 82.53 sq. m

a Websters Estate Agents 36 Broad Street, Teddington, Middlesex TW11 8QY

t 020 8614 6000

e sales@mywebsters.co.uk w mywebsters.co.uk

Disclaimer

These particulars, whilst believed to be accurate are set out as a general outline only for guidance and do not constitute any part of an offer or contract. Intending purchasers should not rely on them as statements of representation of fact, but must satisfy themselves by inspection or otherwise as to their accuracy. We have not carried out a detailed survey nor tested the services, appliances and specific fittings. Room sizes should not be relied upon for carpets and furnishings. The measurements given are approximate. No person in this firm's employment has the authority to make or give any representation or warranty in respect of the property.

