



Websters  
estate agents

# Grove Road, Twickenham, TW2 5NH

Attractive Mid Terrace double fronted 2 bedroom Victorian home in a small residential cul-de-sac with a large sunny private garden and no onward chain. Situated 0.2 miles from local shops, St James Primary and Waldegrave Girls School/Co-ed Sixth Form and just 0.4 miles from Stanley Primary School and Fulwell train station.

Extended at the rear and tastefully presented to offer 903 sq ft of well balanced living space over 2 floors with modern fixtures, fittings and floorings, charming period features, built in storage and pleasing neutral decor throughout.

Front door opens into the spacious living room with wood flooring, a feature fireplace, space for dining and seating and a separate study/play area with doors into the conservatory. A door in the dining area leads to kitchen with fitted units, modern appliances and access to the w.c at the rear. Doors open onto the garden with a courtyard patio area, large lawn, mature planting, shed storage and gated side access. On the first floor are 2 double bedrooms, the family bathroom and hatch access to loft storage.

Located within 0.6 miles of Twickenham Green shops, cafes and restaurants and Strawberry Hill train station.

EPC Rating E

- Attractive Double Fronted Victorian Home
- 2 Bedrooms and Large Upstairs Bathroom
- L-Shaped Mature and Sunny Garden
- No Onward Chain
- Desirable Cul-de-Sac Location
- Open Plan Living Room and Conservatory
- Close to Numerous Popular Schools
- 0.6 Miles from Strawberry Hill Station



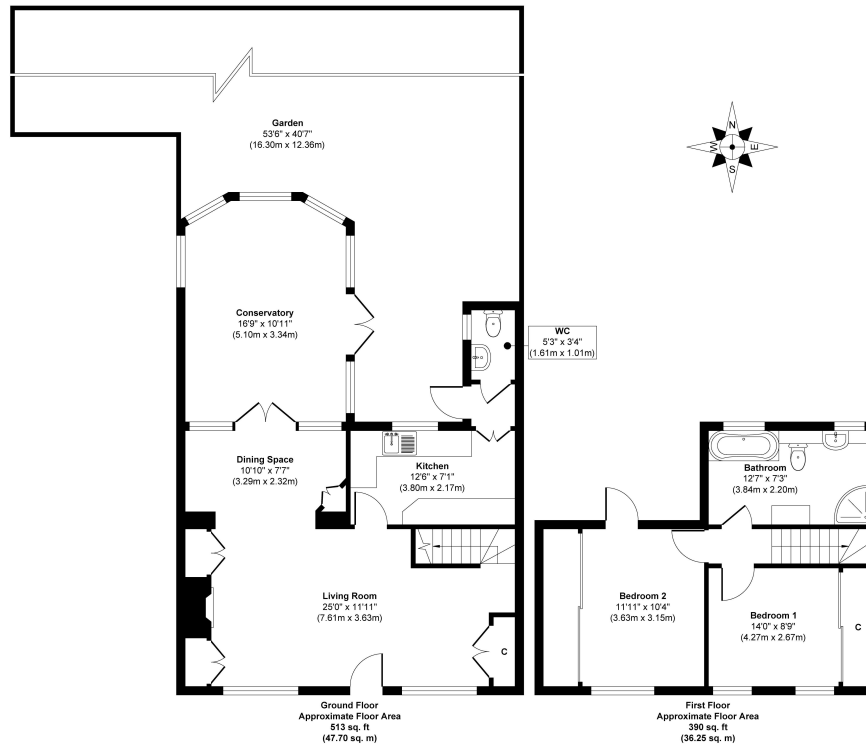

Approx. Gross Internal Floor Area 903 sq. ft / 83.95 sq. m

a Websters Estate Agents 36 Broad Street, Teddington, Middlesex TW11 8QY t 020 8614 6000 e sales@mywebsters.co.uk w mywebsters.co.uk

**Disclaimer**

These particulars, whilst believed to be accurate are set out as a general outline only for guidance and do not constitute any part of an offer or contract. Intending purchasers should not rely on them as statements of representation of fact, but must satisfy themselves by inspection or otherwise as to their accuracy. We have not carried out a detailed survey nor tested the services, appliances and specific fittings. Room sizes should not be relied upon for carpets and furnishings. The measurements given are approximate. No person in this firm's employment has the authority to make or give any representation or warranty in respect of the property.

