



BURTON STREET,
FARSLEY, LEEDS,
LS28 5ET
£150,000

1 Bedroom House

LINLEY &
SIMPSON

CHARACTER LIVING OVER THREE FLOORS. Available for sale chain free is this lovely Stone terraced house in the heart of Farsley. Located just off Old Road in Farsley is this lovely characterful back to back one-bedroom house. Currently rented out this property will be sold with no onward chain.

Farsley is a fantastic village in the heart of Yorkshire located between Horsforth and Pudsey. Famed for being the birthplace of Aston Martin, Farsley's history is rich and long; today its bustling high street with a plethora of shops, pubs, bars and eateries makes Farsley an ideal little village with all the amenities one would ever need. Although leaving Farsley is not necessary, it is easy with it being well connected via bus and road routes as well as via train at New Pudsey Station which is less than a mile and a half from Farsley centre. Brilliant primary schools are also a reason to buy in Farsley and they regularly obtain an 'Outstanding' Ofsted report.

Ground Floor

Entrance

Main entrance into the house is into the ground floor entrance hall which is a nice buffer from the outside.

Living Room

The main reception room on the ground floor is the large living room. With characterful high ceilings and ample space for both living and working in (as the current tenant is using it) this is a nice versatile room which is illuminated by a large front facing window.

Lower Ground Floor

Kitchen/ Diner

The kitchen is a large converted room in the lower ground floor. There is space besides the ample units for a large dining room table within and there is plumbing for a washing machine too. There are two additional open plan sections in the kitchen which are great for storage, and this nice room does have a high window for natural light too.

First Floor

Bedroom

The master bedroom on the first floor and is a front-facing double bedroom. This is a nice, bright room with impressive internal space for furnishings and there are two large alcoves which would be perfect for fitted wardrobes.

House Bathroom

The house bathroom is located on the first floor and benefits from a large, corner-bath, toilet and hand basin all installed to a high standard with tasteful white tiling.



Burton Street, Farsley, Pudsey, LS28

Approximate Area = 777 sq ft / 72 sq m

For identification only - Not to scale



LOWER GROUND FLOOR

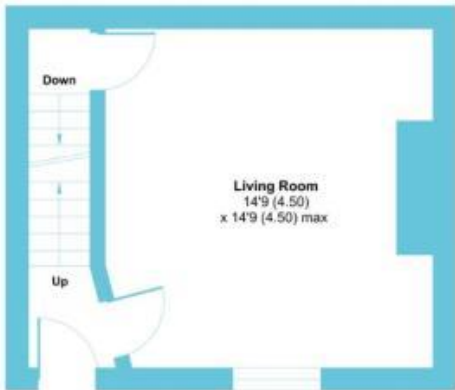

GROUND FLOOR



FIRST FLOOR



Floor plan produced in accordance with RICS Property Measurement Standards incorporating International Property Measurement Standards (IPMS2 Residential). © nichecom 2021. Produced for Linley & Simpson. REF: 796196

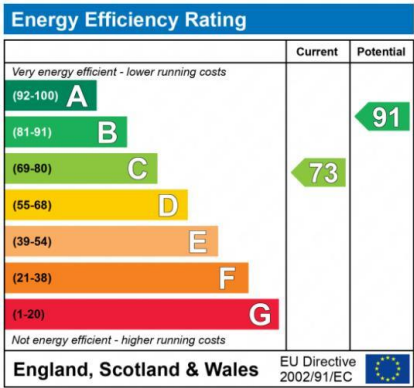

The energy efficiency rating is a measure of the overall efficiency of a home. The higher the rating the more energy efficient the home is and the lower the fuel bills will be.

AGENTS NOTES:

These brochure particulars, including photographic displays, have been prepared by Linley & Simpson Sales Ltd. No implication is made that any item is to be included in the sale by virtue of its inclusion within the photographic display. All fixtures and fittings are excluded from the sale unless included separately within the legal 'fixtures & fittings' details. All measurements are taken in imperial and are approximate. We endeavour to make all the details contained therein accurate and reliable, but they should not be relied upon as statements or representations of fact. Descriptions of appliances, services, systems, fittings and equipment should not be taken as guarantee that they are in working order, they have not been tested (unless stated) and no warranty can be given as to their condition. These particulars do not constitute any part of an offer or contract and we strongly recommend the details should be verified by any prospective purchaser or their advisors, by inspection of the property.