



Northfields



PITSHANGER LANE  
W5

£500,000

Pitshanger



# PITSHANGER LANE, W5

£500,000



Reception Room



Kitchen



Three Bedrooms



Bathroom



On Street Parking

Refurbished to a high standard with great attention to detail is this wonderful three bedroom top (2nd) floor Edwardian mansion apartment. This spacious (807 sq.ft) apartment has been comprehensively refurbished to include rewiring, re-plumbed and sound proofing. Located to the rear of the property there's a private southerly aspect balcony.

Kenmure Mansions is conveniently located on Pitshanger Lane's Award Winning High Street, with its excellent local amenities including a variety of local shops, restaurants, good primary schools, Pitshanger Park and local bus services to Ealing Broadway.

EPC RATING: D

LOCAL AUTHORITY: Ealing

COUNCIL TAX BAND: D

LENGTH OF LEASE: from and including 25 March 2016 to and including 24 March 2141

You may wish to instruct us about a related service, including: the sale and letting of residential and commercial property, the provision of mortgage and financial services, conveyancing and property management. Where you choose to use other services, Northfields or its employees may receive a fee or commission which will be disclosed to you.

Approximate Gross Internal Area  
75 sq m / 807 sq ft



 = Reduced headroom below 1.5m / 5'0"

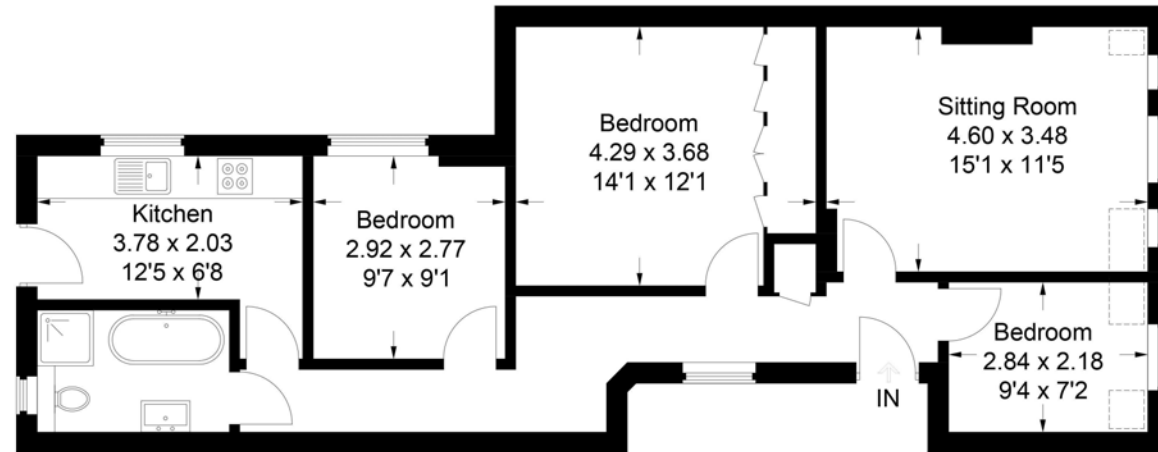

This plan is for layout guidance only. Not drawn to scale unless stated. Windows and door openings are approximate. Whilst every care is taken in the preparation of this plan, please check all dimensions, shapes and compass bearings before making any decisions reliant upon them.  
© CJ Property Marketing Ltd Produced for Brendons

**CONTACT**  
*Us today*  
 TO FIND OUT  
**MORE**

[www.northfields.co.uk](http://www.northfields.co.uk)  
 020 8998 3111

**Pitshanger**  
 | Albert Terrace  
 Ealing  
 London W5 1RL  
 Sales: 020 8998 3111  
 E: [pitssales@northfields.co.uk](mailto:pitssales@northfields.co.uk)

Your local independent  
 award winning estate agents

