



ADT

80

P Permit holders only
Mon - Sat
8.30 am - 6.30 pm

Websters
estate agents

May Road, Twickenham, TW2 6RL

Mid Terrace 4 double bedroom Victorian family home in a popular residential location with a west facing garden. Situated just 0.1 mile from Twickenham Green, 0.3 miles from Archdeacon Primary, 0.5 miles from Trafalgar Primary and St Richard Reynolds School and 0.8 miles from Waldegrave Girls School/Co-ed Sixth Form.

Extended, loft converted and refurbished to an impressive standard to offer 1286 sq ft of living space over 3 floors with high specification fixtures, fittings and floorings, traditional sash windows, some plantation style shutters, energy efficient heating, lighting and appliances and neutral decor throughout.

Entrance hallway leads to the open plan living/family room with access to a w.c and the stunning kitchen/dining room at the rear. This light filled room has a bespoke integrated kitchen with a breakfast bar, tiled flooring, velux roof windows and a fabulous feature brick wall. Folding doors open onto the garden with a patio, astroturf lawn, shed storage and gated rear access. On the first floor are 2 bedrooms, the family bathroom and stairs up to 2 further bedrooms the main with an en-suite shower room and eaves storage.

Located 0.6 miles from Strawberry Hill train station and Twickenham town centre and 0.9 miles from Twickenham mainline train station.
EPC Rating C

- Mid Terrace Victorian Home
- 4 Bedrooms and 2 Bathrooms
- West Facing Garden with Rear Access
- Extended and Loft Converted
- High Specification Throughout
- Desirable Twickenham Green Area
- Close to Numerous Popular Schools
- 0.1 Mile from Twickenham Green



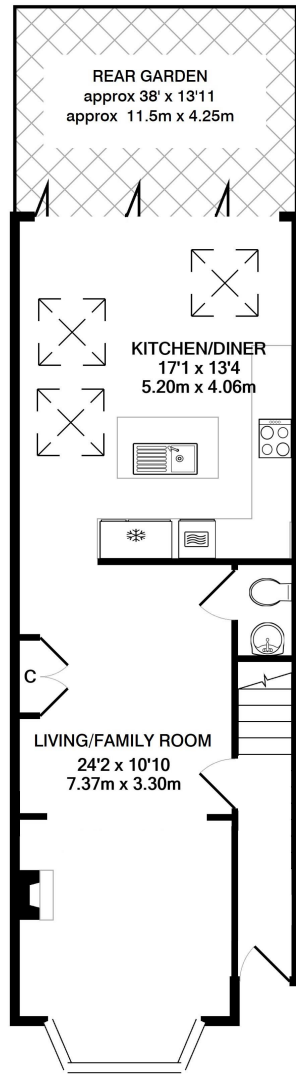

GROUND FLOOR
APPROX. FLOOR
AREA 562 SQ.FT.
(52.2 SQ.M.)

RECEPTION ROOM



1ST FLOOR
APPROX. FLOOR
AREA 387 SQ.FT.
(36.0 SQ.M.)

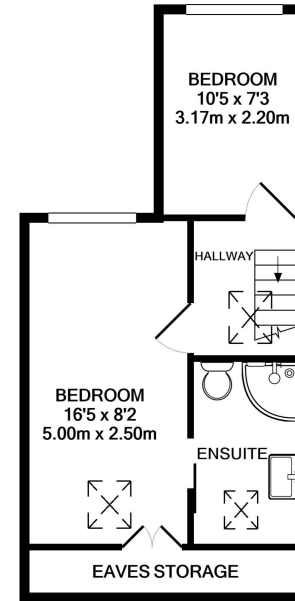

2ND FLOOR
APPROX. FLOOR
AREA 336 SQ.FT.
(31.2 SQ.M.)

TOTAL APPROX. FLOOR AREA 1286 SQ.FT. (119.4 SQ.M.)

Disclaimer

These particulars, whilst believed to be accurate are set out as a general outline only for guidance and do not constitute any part of an offer or contract. Intending purchasers should not rely on them as statements of representation of fact, but must satisfy themselves by inspection or otherwise as to their accuracy. We have not carried out a detailed survey nor tested the services, appliances and specific fittings. Room sizes should not be relied upon for carpets and furnishings. The measurements given are approximate. No person in this firm's employment has the authority to make or give any representation or warranty in respect of the property.

