



WIGHTON  
MEWS

Websters  
estate agents

# Wighton Mews, Isleworth, TW7 4DZ

End of Terrace 4 bedroom modern townhouse in a popular secure gated development with 2 allocated parking spaces and a private south facing garden. Situated within 0.8 miles of Isleworth Town Primary, Marlborough Primary and The Green School.

Currently Let this pleasing property has no onward chain. Tastefully presented and offering 1489 sq ft of living space over 3 floors with modern fixtures and fittings, double glazed windows and doors and pleasing neutral decor.

Front door opens to the entrance hallway with access to a w.c, the fitted kitchen and the living room and conservatory at the rear. Doors open onto the south facing garden with a patio, lawn and shed storage. On the first floor are 2 double bedrooms the master with built in storage and an en-suite shower room. Stairs lead up to 2 further bedrooms and the family bathroom

Located less than 0.1 mile from local shops, 0.2 miles from Isleworth train station and 0.7 miles from Osterley station (Piccadilly Line).  
EPC Rating C

- End of Terrace Modern Townhouse
- 4 Double Bedrooms and 2 Bathrooms
- 2 Allocated Parking Spaces
- Secure Gated Development
- South Facing Garden with Side Access
- Living Room, Conservatory and Separate Kitchen
- No Onward Chain
- 0.2 Miles from Isleworth Train Station



3 Wighton Mews, TW7 4DZ



GROUND FLOOR  
APPROX. FLOOR  
AREA 53.9 SQ.M  
(581 SQ.FT.)

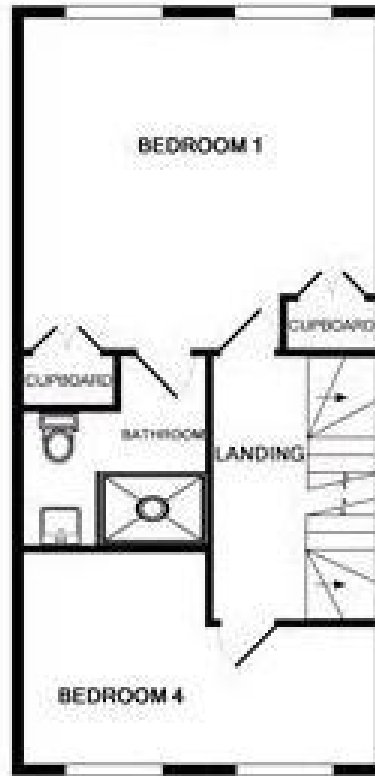

1ST FLOOR  
APPROX. FLOOR  
AREA 42.2 SQ.M  
(454 SQ.FT.)

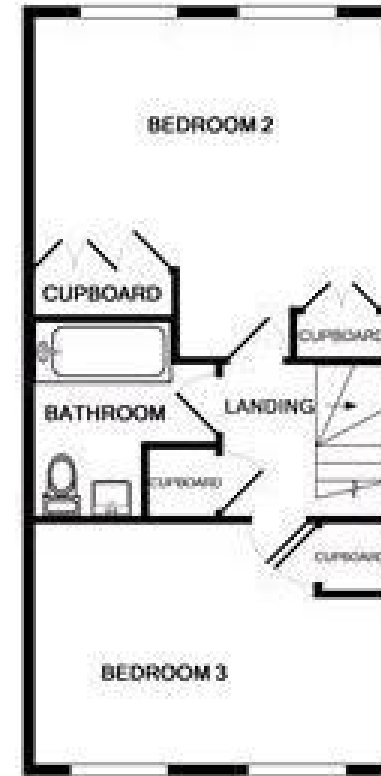

2ND FLOOR  
APPROX. FLOOR  
AREA 42.2 SQ.M  
(454 SQ.FT.)

TOTAL APPROX. FLOOR AREA 138.4 SQ.M. (1489 SQ.FT.)

a Websters Estate Agents 164 Heath Road, Twickenham, Middlesex TW1 4BN t 020 8892 3343 e sales@mywebsters.co.uk w mywebsters.co.uk

Disclaimer  
These particulars, whilst believed to be accurate are set out as a general outline only for guidance and do not constitute any part of an offer or contract. Intending purchasers should not rely on them as statements of representation of fact, but must satisfy themselves by inspection or otherwise as to their accuracy. We have not carried out a detailed survey nor tested the services, appliances and specific fittings. Room sizes should not be relied upon for carpets and furnishings. The measurements given are approximate. No person in this firm's employment has the authority to make or give any representation or warranty in respect of the property.

