



WHITE HART
LANE N17
LUTON MK17 9 2AA

Websters
estate agents

488 Chertsey Road, Twickenham, TW2 6LR

Forming part of the popular Counties Estate. Lovely 3 double bedroom semi detached family home with 1167 sq ft of well balanced accommodation.

Extended to the side and rear, this very well presented house has a modern and stylish interior with a contemporary, light and airy feel throughout.

Entrance hallway leads to the spacious front reception room, open plan kitchen/breakfast room, utility room and separate w.c. Double doors between the reception room and kitchen allow for open plan family living.

Bifold doors in the kitchen open directly onto the 60ft garden with a patio, planting and lawned area and side access.

Upstairs are 3 double bedrooms, the master with an en-suite shower, and a beautifully fitted luxury bathroom.

Potential to loft convert and create additional living space (subject to Planning permission and building regulations)

Situated in Twickenham close to Crane Park and Kneller Gardens.

EPC Rating D.

- 3 Double Bedroom Semi
- Stylish and Modern Interior
- 1167 Sq Ft of Accomodation
- Large Kitchen/Breakfast Room
- Downstairs W.C
- Luxury Family Bathroom
- Potential to Loft Convert (stpp)



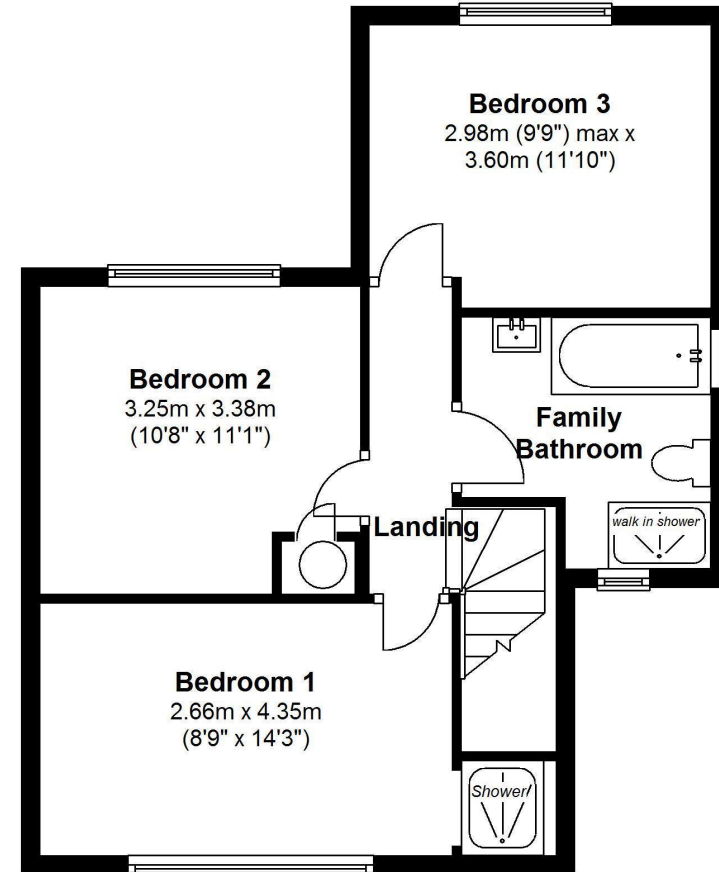
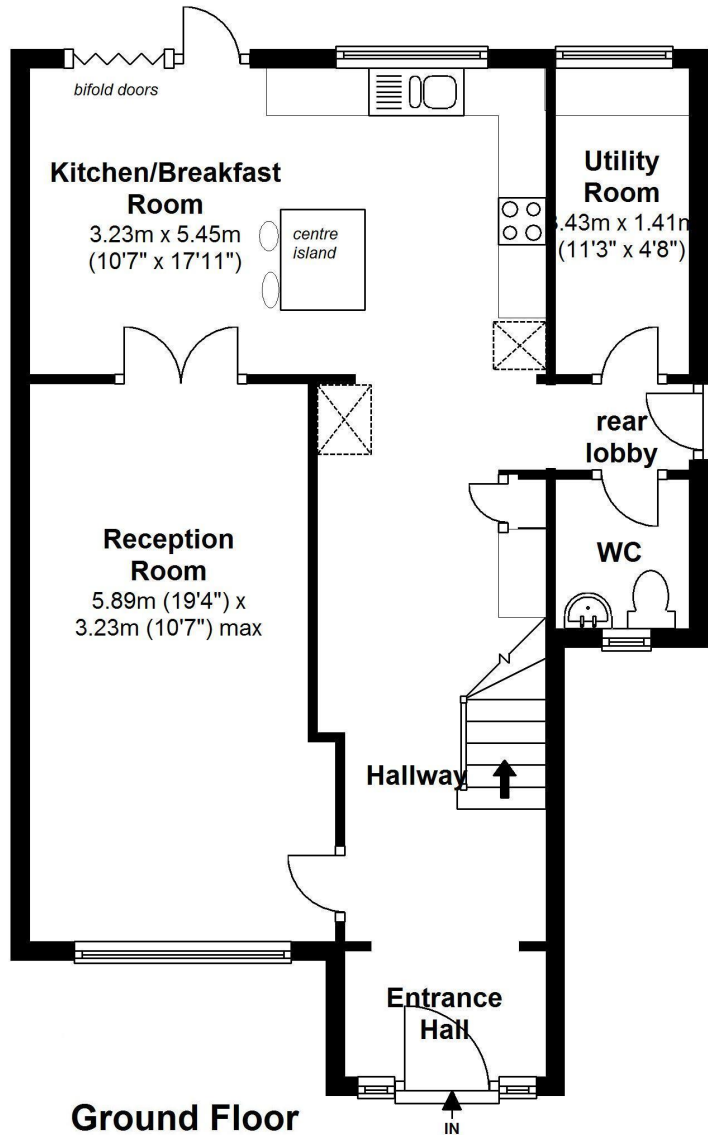

Gross Floor area approx.=1,167 Sq.Feet (108 sq.metres)

