



Websters
estate agents

May Road, Twickenham, TW2 6QP

Mid Terrace 4 bedroom Victorian family home in a popular residential location with a west facing garden. Situated just 0.1 mile from Twickenham Green and local shops, within 0.5 miles of Archdeacon, TPA, Trafalgar and St Richard Reynolds and 0.8 miles from Waldegrave Girls/Co-ed Sixth Form.

With no onward chain, extended and loft converted and tastefully presented to offer 1375 sq ft of well balanced living space over 3 floors with period features, modern fixtures, fittings and floorings, sash windows, folding doors, some plantation style shutters and neutral decor throughout.

Entrance hallway leads to the spacious living area with a bay fronted sitting room and a large family area with a w.c and open access to the stylish integrated kitchen with a breakfast bar and space for dining/seating. Full width folding doors open onto the garden with a patio, artificial lawn, shed storage and gated rear access.

On the first floor are 2 bedrooms, the family bathroom and stairs up to 2 further bedrooms, the main with an ensuite shower room, juliet balcony and eaves storage.

Located 0.6 miles from Strawberry Hill train station and Twickenham town centre and within 0.9 miles of Twickenham mainline train station and Church Street shops, cafes and Thames Riverside with a walking/cycle track past Marble Hill Park to Richmond.

EPC Rating D

- Mid Terrace 4 Bedroom Home
- No Onward Chain
- Spacious Open Plan Family Living
- 1375 Sq Ft of Living Space over 3 Floors
- Private West Facing Garden
- Within 0.8 Miles of Popular Schools
- 0.1 Mile from Twickenham Green



May Road

Approx. Gross Internal Area
128 Sq M - 1375 Sq Ft
(Excluding Eaves Storage)

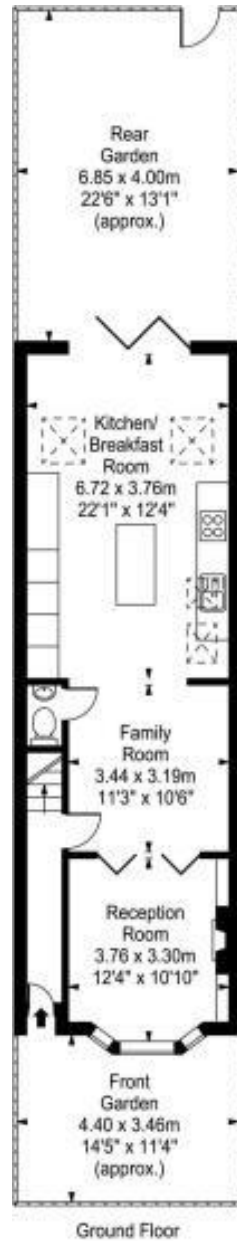

a Websters Estate Agents 36 Broad Street, Teddington, Middlesex TW11 8QY

t 020 8614 6000

e sales@mywebsters.co.uk w mywebsters.co.uk

Disclaimer

These particulars, whilst believed to be accurate are set out as a general outline only for guidance and do not constitute any part of an offer or contract. Intending purchasers should not rely on them as statements of representation of fact, but must satisfy themselves by inspection or otherwise as to their accuracy. We have not carried out a detailed survey nor tested the services, appliances and specific fittings. Room sizes should not be relied upon for carpets and furnishings. The measurements given are approximate. No person in this firm's employment has the authority to make or give any representation or warranty in respect of the property.

