



**BOSTON PARK ROAD
TW8**

£180,000 (75%) £240,000 (100%)

Brentford



BOSTON PARK ROAD, TW8

£180,000 (75%) £240,000 (100%)



Reception Room



Kitchen



One Bedroom



Bathroom



No Parking

***75% shared ownership available at £180,000 / 100% Ownership
- £240,000 for first time buyers ***

Located on the top floor this flat has fantastic views of the city and showcases a generous double bedroom, an open plan kitchen/reception which is flooded with natural light, a well-presented shower room, communal gardens and access to a shared roof terrace.

Conveniently located half-way between Boston Manor Piccadilly line station and Brentford mainline station and within easy reach of the A4/M4 for those that drive.

EPC RATING: C
LOCAL AUTHORITY: Brentford
COUNCIL TAX BAND: C

PARAGON SITE

Approximate Gross Internal Area
398 sq ft / 37.0 sq m

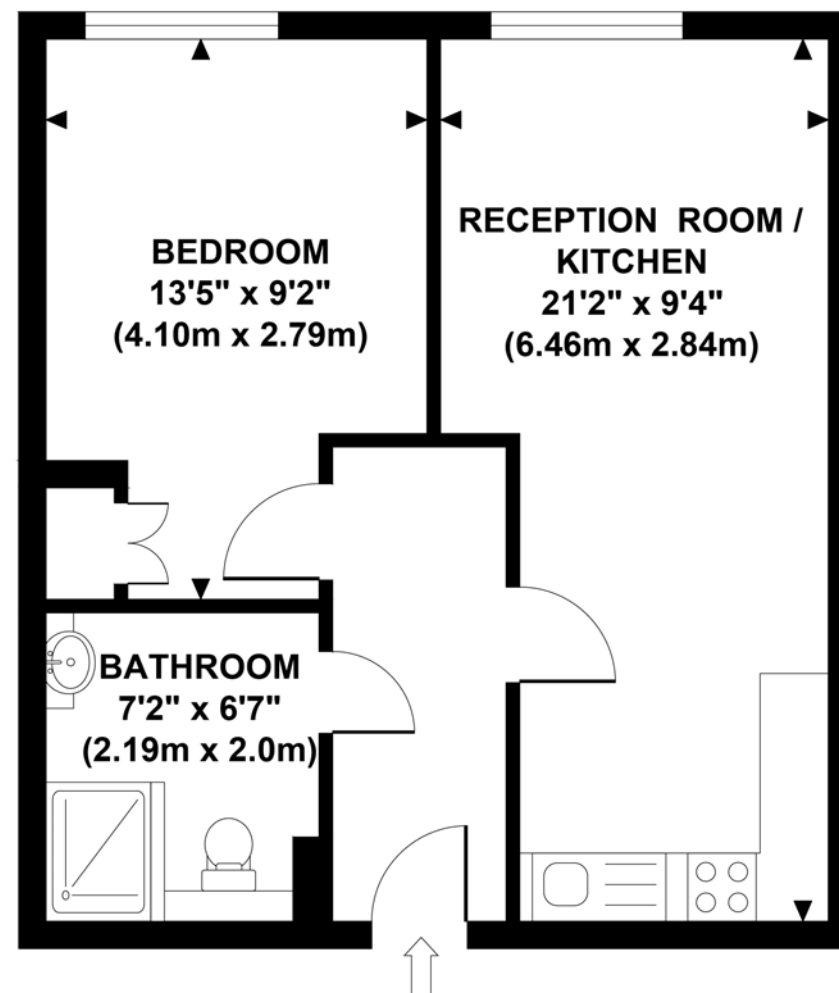

7TH FLOOR
GROSS INTERNAL
FLOOR AREA 398 SQ FT

Although every attempt has been made to ensure accuracy, all measurements are approximate.
The floor plan's for illustrative purposes only and not to scale. Measured in accordance to RICS standards.
GRG PRO PHTOS

Your local independent
award winning estate agents



Northfields

130-132 Northfield Avenue,
Ealing W13 9RT
Sales: 020 8840 6666
E: nasales@northfields.co.uk

020 8840 6666

www.northfields.co.uk

CONTACT

Us today

TO FIND OUT

MORE