



Northfields

HODDER DRIVE
UB6

£330,000

Fixed price

Perivale



HODDER DRIVE, UB6

£330,000



Living/ Dining Room



Kitchen



Two Bedrooms



Bathroom



Garage

An impressive two double bedroom first floor flat, with a private balcony and a garage. The property offers a good sense of space, both bedrooms are genuine doubles and there's a 17ft living/dining room which has a sliding door leading out to the balcony. The flat is flooded with lots of natural light, and benefits from being situated in a peaceful residential street.

Cotswold Court is a small purpose built block of just 16 flats located on Hodder Drive, a quiet residential street in the popular Medway Village. Situated within easy reach of Perivale underground station and local amenities. The property also falls in the catchment area for the outstanding Selborne Primary school.

EPC RATING: D
LOCAL AUTHORITY: Ealing
COUNCIL TAX BAND: C

Cotswold Court, Perivale

Approximate Gross Internal Area (Excluding Garage)

60.7 sq m / 653 sq ft

External Balcony = 2.14 sq m / 23 sq ft

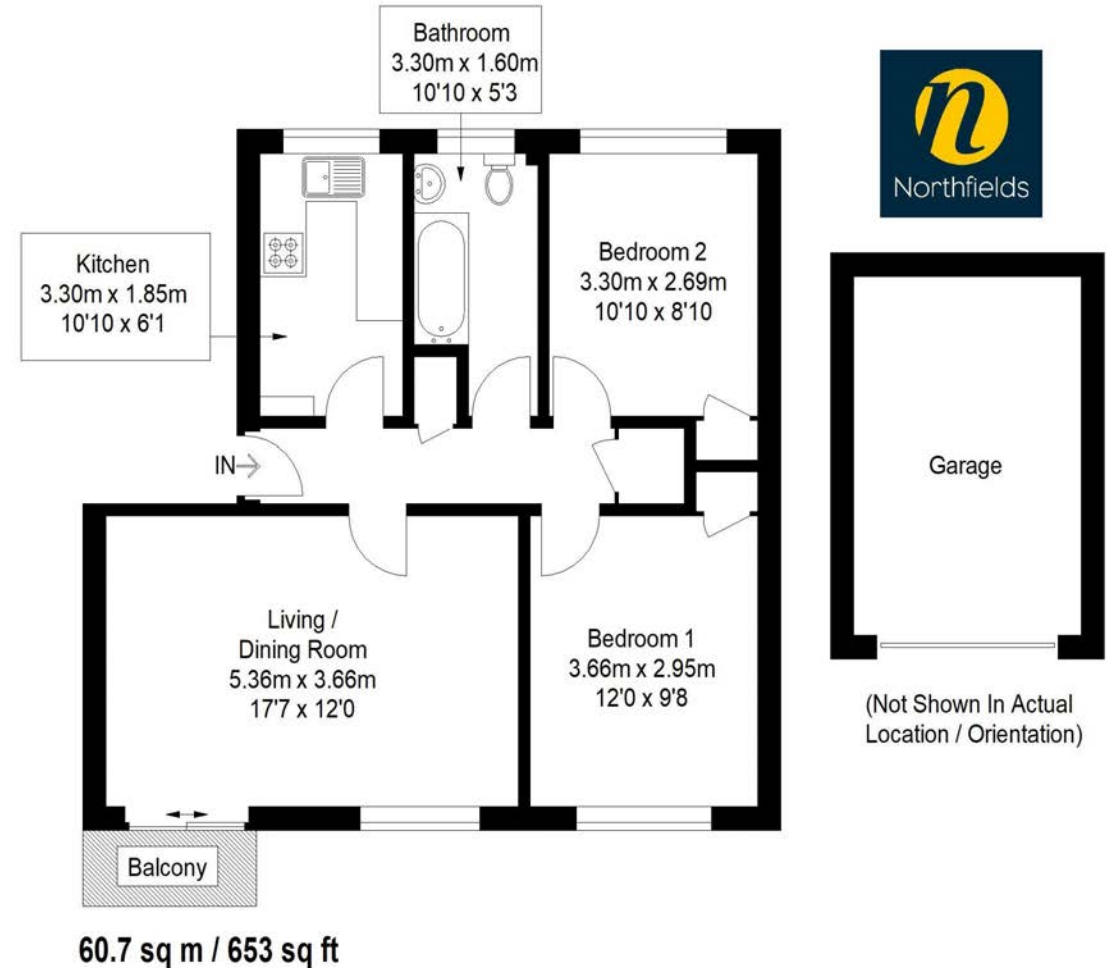

Cube Property Marketing © 2019
Illustration for identification purposes only,
measurements are approximate, not to scale.

Your local independent
award winning estate agents



Pitshanger

1 Albert Terrace
Ealing
London W5 1RL
Sales: 020 8998 3111
E: pitssales@northfields.co.uk

020 8998 3111

www.northfields.co.uk

CONTACT

Us today

TO FIND OUT

MORE