



Websters
estate agents

0156 WOU

Warwick Road, Twickenham, TW2 6SW

End of Terrace Victorian 2 double bedroom family home in a popular, residential cul-de-sac location. Situated just 0.3 miles from Twickenham Green, local shops, bars and restaurants, 0.5 miles from Twickenham town centre and just 0.7 miles from Strawberry Hill and Twickenham mainline station.

With no onward chain, extended at the rear and tastefully presented to offer 936 sq ft of living space over 3 floors with a converted loft room suitable for use as a home office/play room, modern fixtures, fittings and floorings, double glazed windows and doors and pleasing neutral decor throughout.

Entrance hallway leads to the spacious open plan living/dining room with wood flooring, feature fireplaces and access into the kitchen/breakfast room with a tiled floor and fitted units. A door at the rear opens to the attractive low maintenance garden with shed storage and secure gated access. On the first floor are 2 double bedrooms, the family bathroom and fixed wooden paddle steps leading up to the loft room. This adaptable space is fully useable with power, heating and velux roof windows.

Located within 0.4 miles of Archdeacon, TPA and St Richard Reynolds, 0.6 miles from Trafalgar and 0.9 miles from Waldegrave Girls School/Co-ed Sixth Form.
EPC Rating D

- End of Terrace 2 Bedroom Victorian Home
- Upstairs Bathroom and Fixed Steps to Loft Room
- No Onward Chain
- Garden with Gated Side Access
- 936 Sq Ft of Living Space (Including Loft Room)
- 0.3 Miles from Twickenham Green
- Close to Numerous Popular Schools



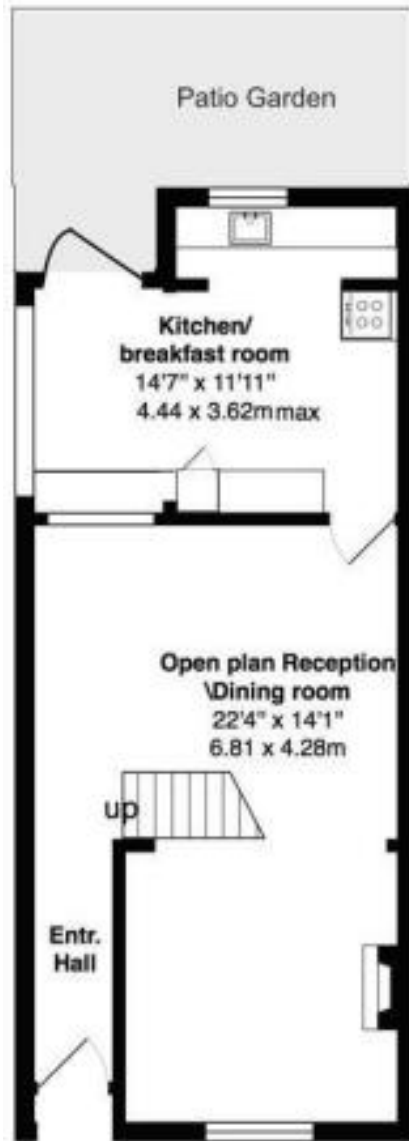

GROUND FLOOR

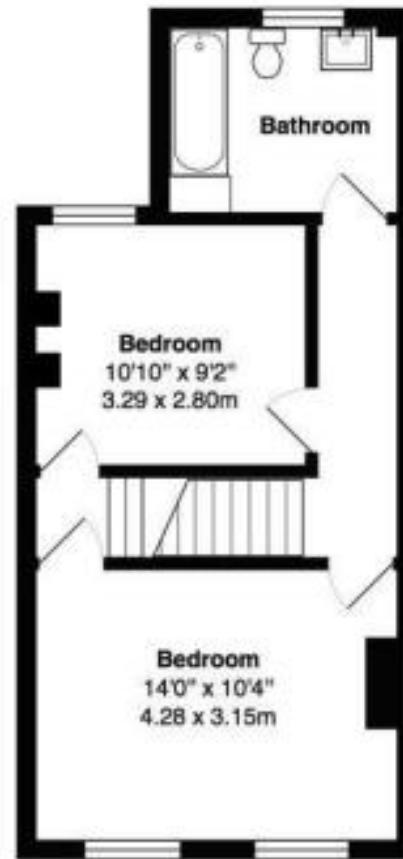

FIRST FLOOR

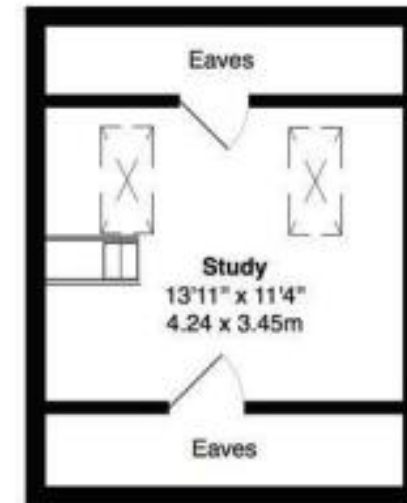

LOFT

TOTAL FLOOR AREA approx.= 936 Sq.Feet (87 sq.metres)
(incl. Study/loft)

[a Websters Estate Agents 36 Broad Street, Teddington, Middlesex TW11 8QY](http://www.websters.co.uk) [t 020 8614 6000](tel:02086146000) [e sales@mywebsters.co.uk](mailto:sales@mywebsters.co.uk) [w mywebsters.co.uk](http://www.mywebsters.co.uk)

Disclaimer
These particulars, whilst believed to be accurate are set out as a general outline only for guidance and do not constitute any part of an offer or contract. Intending purchasers should not rely on them as statements of representation of fact, but must satisfy themselves by inspection or otherwise as to their accuracy. We have not carried out a detailed survey nor tested the services, appliances and specific fittings. Room sizes should not be relied upon for carpets and furnishings. The measurements given are approximate. No person in this firm's employment has the authority to make or give any representation or warranty in respect of the property.

