



2
Orion
Security

3

1000

Websters
estate agents

May Road, Twickenham, TW2 6QW

Stunning Mid Terrace 2 double bedroom Victorian Home in a desirable residential area less than 100 metres from Twickenham Green, local shops, cafes and restaurants, 0.5 miles from Strawberry Hill train station and 0.8 miles from Twickenham Station.

Completely refurbished internally and externally to an impressive standard to offer 722 sq ft of immaculate and well proportioned living space over 2 floors with high specification fixtures, fittings and floorings, energy efficient boiler, central heating and lighting, built in storage, double glazed windows and doors and pleasing neutral decor throughout.

Entrance hallway leads to the living room, understairs storage and the dining/family room at the rear with space for seating and dining and access to the stylish bespoke integrated kitchen. A door opens onto the low maintenance walled and secluded rear garden. On the first floor are 2 double bedrooms, the family bathroom and hatch access to loft storage

Located within 0.4 miles of Archdeacon and Trafalgar Primary Schools, 0.7 miles of St Richard Reynolds and Waldegrave Girls/Co-ed Sixth Form and 0.3 miles from Kneller Gardens with a bike/towpath track along the River Crane to Crane Park.

EPC Rating C

- Mid Terrace Victorian Home
- Completely Refurbished Throughout
- 2 Double Bedrooms and Upstairs Bathroom
- High Specification Throughout
- No Onward Chain
- Less than 100m from Twickenham Green
- 0.5 Miles from Strawberry Hill Station



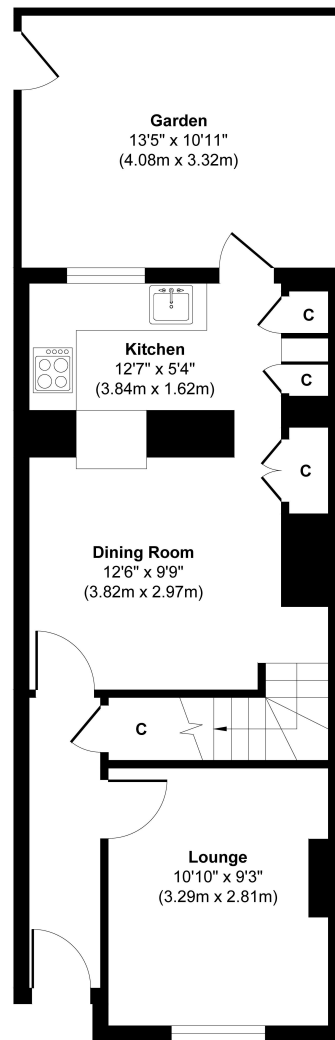

Ground Floor
 Approximate Floor Area
 388 sq. ft
 (36.12 sq. m)

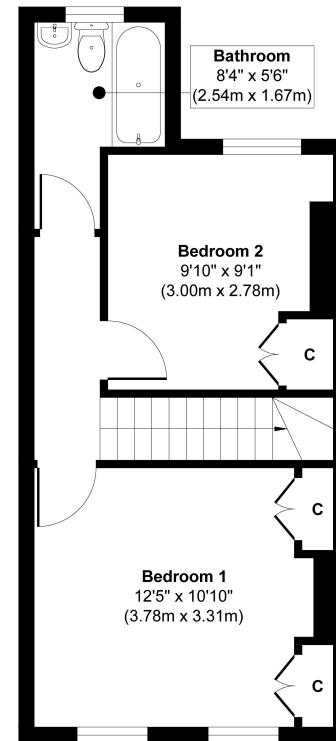

First Floor
 Approximate Floor Area
 334 sq. ft
 (31.03 sq. m)

Approx. Gross Internal Floor Area 722 sq. ft / 67.15 sq. m

