



PLOT 29 BONDGATE

LANGTHORPE, YO51 9DE

£117,250 Shared Ownership

LINLEY &
SIMPSON

Land & New Homes

PLOT 29, BONDGATE LANGTHORPE

A limited number of properties are being made available for shared ownership on this new development in Langthorpe. Built by Taylor Wimpey, these brand new properties are situated in a superb location with good proximity to local amenities. S106 Local Occupancy planning condition applies.

Bondgate is a stunning collection of two, three and four bedroom homes, set in the idyllic village of Langthorpe, close to the vibrant town of Boroughbridge. Each property offers bright, open rooms, finished to a good standard and thoughtfully laid out.

This two bedroom semi detached property will appeal to first time buyers, couples and families looking for a little extra space. A large and light open plan lounge / dining room and kitchen space opens through French doors to the private rear garden, making it perfect for entertaining. A guest cloakroom, store cupboard and downstairs toilet complete the ground floor layout.

The first floor comprises the spacious principal bedroom, a main bathroom, and an additional double bedroom.

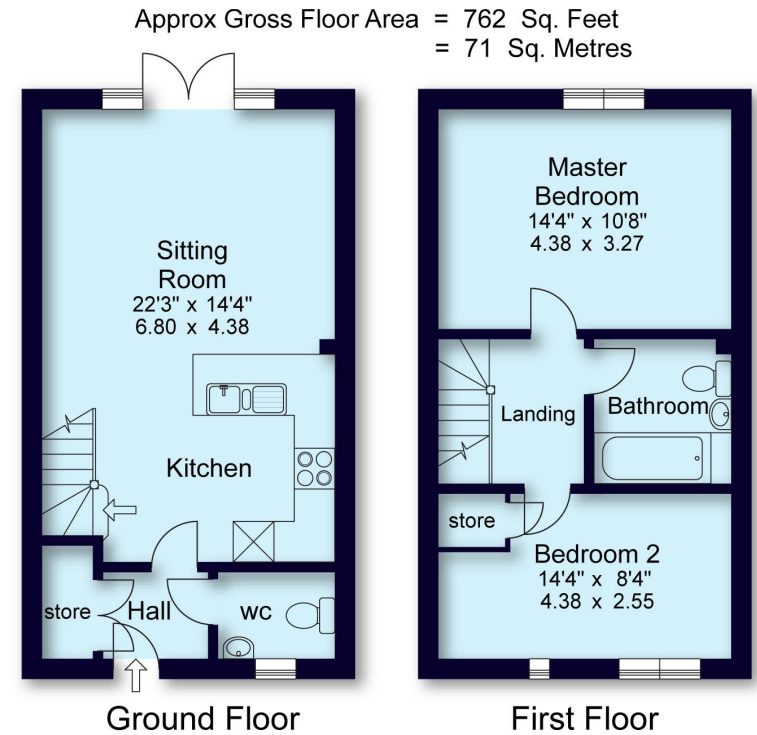

For illustrative purposes only. Not to scale.



Please note images are for illustrative purposes only.

SHARED OWNERSHIP

Shared Ownership is a government-backed scheme and a great way to get on to the property ladder when you can't quite afford to buy a home on the open market. Based upon your affordability, you can buy an initial share of your home and make a small monthly payment to rent the remaining share.

You may be able to buy further shares at a later stage, however, in some cases there may be restrictions on when you can buy a further share or on the maximum total share you can own.

You qualify for shared ownership if you:

- Have a household income of under £80,000
- Don't currently own your home and can't afford to on the open market
- Can afford the minimum deposit
- Pass an affordability check to make sure you can get a mortgage

SHARES

Price £234,500 at 100%

50% Share for £117,250

Rent (pcm) - £268.70

Other shares are available based on individual criteria and subject to assessment by Incommunities.

TENURE

Although properties are Freehold, they will be sold on a Leasehold basis if shared ownership arrangements are in place.

ESTATE CHARGE OF £133.33 PER UNIT PER ANNUM to be paid by purchaser.

VIEWING & PURCHASING PROCEEDURE

Prior to viewing, all interested parties should complete an initial application and eligibility form (please enquire for further information). Please note that properties are allocated on a 'first come first served basis' and that a £500 non-refundable reservation fee is required to secure a particular property (this will be deducted from the final price upon completion).



12 Albert Street, Harrogate HG1 1JG

T: 01423 540054 (option 3)

E: landandnewhomes@linleyandsimpson.co.uk

www.linleyandsimpson.co.uk



AGENTS NOTES:

These brochure particulars, including photographic displays, have been prepared by Linley & Simpson Ltd. No implication is made that any item is to be included in the sale by virtue of its inclusion within the photographic display. All fixtures and fittings are excluded from the sale unless included separately within the legal 'fixtures and fittings' details. All measurements taken in imperial and metric are approximate. We endeavour to make all the details contained therein accurate and reliable, but they should not be relied upon as statements or representations of fact. Descriptions of appliances, services, systems, fittings and equipment should not be taken as guarantee that they are in working order, they have not been tested (unless stated) and no warranty can be given as to their condition. These particulars do not constitute any part of an offer or contract and we strongly recommend the details should be verified by any prospective purchaser or their advisors, by inspection of the property.