



Northfields

CATHERINE WHEEL ROAD
TW8

£1,000 per month

Brentford



CATHERINE WHEEL ROAD, TW8

£1,000 per month



Reception Room



Kitchen



One Bedroom



1 Bathroom



No Parking

A unique opportunity to live on this incredible ONE bedroom HOUSE-BOAT on this secure residential mooring in the centre of Brentford, along the River Brent. The Fair Triumvirate is a beautifully finished houseboat, fitted out to a high specification throughout. Comprising an open-plan kitchen reception area with a wood burning stove and a fitted kitchen with hard wood work surfaces and storage. There is a bedroom with a hatch which opens out for a stunning view of the River, plus a shower room with cassette WC. There is an additional fixed charge for electricity, water and council tax of £150 per month - with tenants paying separately for LPG for cooking and Diesel for the central heating system. Entrance is via a secure gate down to the mooring and a laundry block on land with washing machine and tumble dryer.

EPC RATING: A

LOCAL AUTHORITY: London Borough of Hounslow (Electricity, Council Tax & Water - additional £150pcm)

To move into this property you will need to pay rent in advance (usually monthly in advance) as well as a deposit of 5 weeks rent (or have a Zero Deposit policy in place if applicable.) Details of permitted payments and default fees can be found in our Tenant Guide and Tenancy Agreement.

Most tenancies are Assured Shorthold Tenancies. If you are not renting this property under an Assured Shorthold Tenancy or licence agreement then you will also have to pay the following prior to the commencement of a tenancy: Administration fee (£300 inclusive of VAT); Referencing fee (£75 per tenant/guarantor); Inventory check (prices vary depending on size and furnishing of the property.)

Please note, the rent advertised is pure rent and does not include any additional services such a

THE FAIR TRIUMVIRATE, TOWN WHARF

Approximate Gross Internal Area

182 sq ft / 16.90 sq m

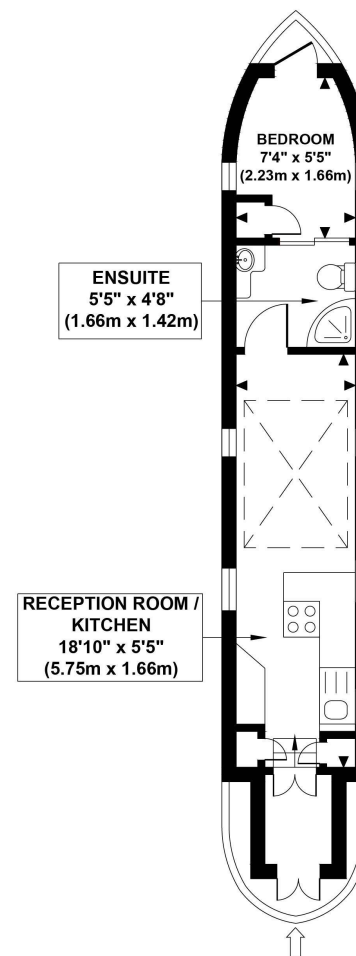

**GROSS INTERNAL
FLOOR AREA 182 SQ FT**

Although every attempt has been made to ensure accuracy, all measurements are approximate and no responsibility is taken for any error, omission, or mid-statement. This floor plan is for illustrative purposes only and not to scale. Measured in accordance to RICS standards.
GB PRO PHOTOS

Your local independent,
award winning estate agents



Northfields

130-132 Northfield Avenue,
Ealing W13 9RT
Lettings: 020 8567 6660
E: enquiries@northfields.co.uk

020 8567 6660

www.northfields.co.uk

CONTACT

Us today

TO FIND OUT

MORE