



Northfields

MALVERN WAY
W13

£360,000 Fixed Price

Pitshanger



MALVERN WAY, W13

£360,000



17ft Reception Room



Kitchen



One Bedroom



Bathroom



Residents Parking

A beautifully presented one bedroom first floor purpose built apartment, with a private balcony. The property offers a generous 533 sq.ft of accommodation, and benefits from lots of natural light and a share in the freehold. Located on the popular Cleveland Estate, set in well-kept communal grounds close to the open spaces of both Pitshanger and Cleveland Parks.

Also close by is Pitshanger Lane's Award Winning High Street, with its excellent local amenities including a variety of local shops, restaurants, and local bus services to Ealing Broadway.

EPC RATING: D

LOCAL AUTHORITY: London Borough of Ealing

COUNCIL TAX BAND: C

LEASE: 999 years from 24 June 1964

You may wish to instruct us about a related service, including: the sale and letting of residential and commercial property, the provision of mortgage and financial services, conveyancing and property management. Where you choose to use other services, Northfields or its employees may receive a fee or commission which will be disclosed to you.

GLENEAGLES

Approximate Gross Internal Area 553 sq ft / 51.4 sq m

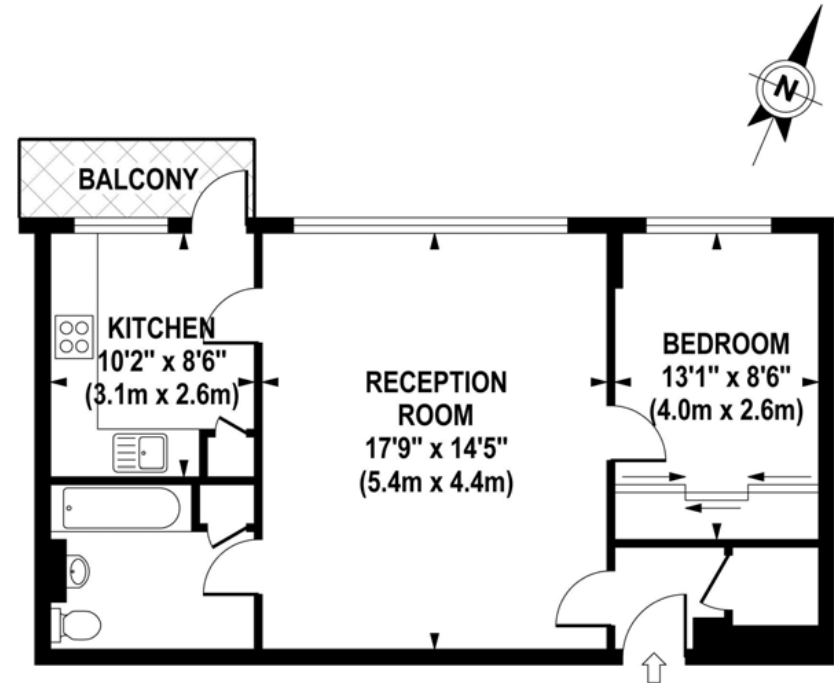

FIRST FLOOR
GROSS INTERNAL
FLOOR AREA 553 SQ FT

Although every attempt has been made to ensure accuracy, all measurements are approximate. The floor plan's for illustrative purposes only and not to scale. Measured in accordance to RICS standards.

DE-PHOTOGRAPHY.NET

CONTACT
Us today
 TO FIND OUT
MORE

www.northfields.co.uk
 020 8998 3111

Pitshanger
 | Albert Terrace
 Ealing
 London W5 1RL
 Sales: 020 8998 3111
 E: pitssales@northfields.co.uk

Your local independent
 award winning estate agents

