



Websters  
ESTATE AGENTS  
01793 8862343  
www.websters.co.uk  
For Sale

Websters  
estate agents



# 35 Warwick Road, Twickenham, TW2 6SW

Open Day viewings with best and final offers to be submitted by 10th March 2014.

Mid terrace, 2 double bedroom Victorian cottage in a popular residential road only 0.3 miles from Twickenham Green and the local shops.

Attractive and well presented home offering 748sq ft of well balanced accommodation over 2 floors.

Front door leads into the dual aspect open plan living room with a door to the separate fitted kitchen at the rear and access onto the pretty west facing patio garden.

Upstairs are 2 double bedrooms and the modern family bathroom.

In an unrestricted parking zone and just 0.7 miles from Twickenham mainline train station and Strawberry Hill station.

EPC Rating: E

- Victorian Mid Terrace Cottage
- Open Plan Living Room
- Fitted Kitchen
- 2 Double Bedrooms
- Upstairs Bathroom
- West Facing Garden
- 0.7 Miles from Twickenham Mainline Station



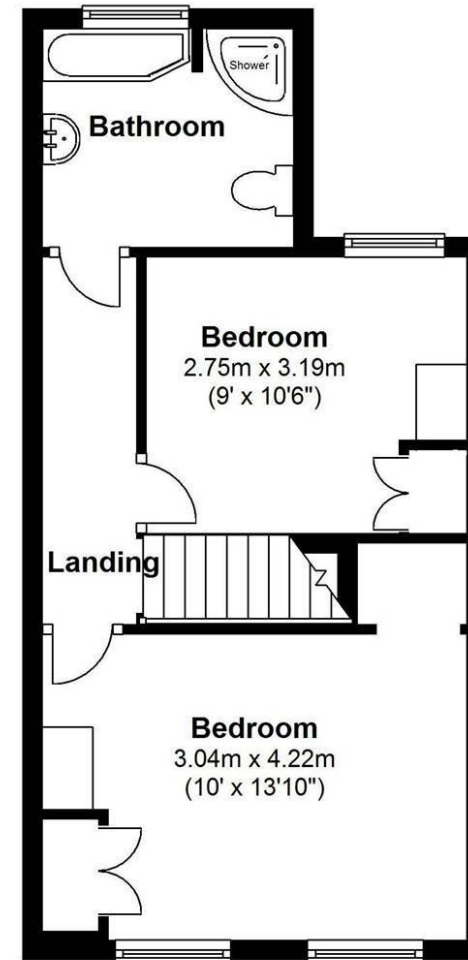
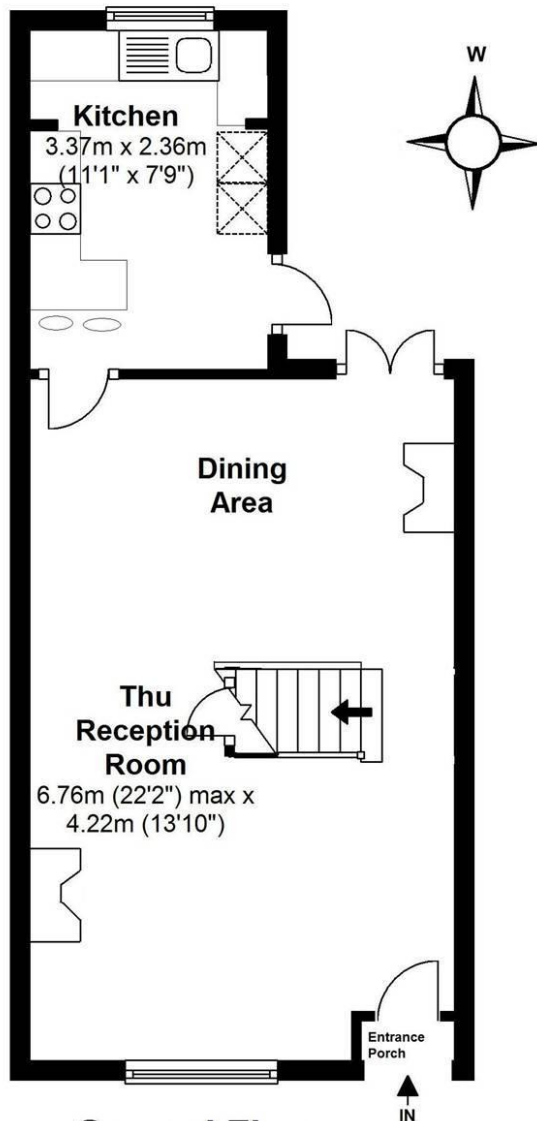

Gross Floor area approx. = 748 Sq.Feet (69.45 sq.metres)

**a** Websters Estate Agents 36 Broad Street, Teddington, Middlesex TW11 8QY

**t** 020 8614 6000

**e** sales@mywebsters.co.uk **w** mywebsters.co.uk

**Disclaimer**

These particulars, whilst believed to be accurate are set out as a general outline only for guidance and do not constitute any part of an offer or contract. Intending purchasers should not rely on them as statements of representation of fact, but must satisfy themselves by inspection or otherwise as to their accuracy. We have not carried out a detailed survey nor tested the services, appliances and specific fittings. Room sizes should not be relied upon for carpets and furnishings. The measurements given are approximate. No person in this firm's employment has the authority to make or give any representation or warranty in respect of the property.



