



Northfields

ABBNEYFIELDS CLOSE
NW10

£360,000

Park Royal



ABBEYFIELDS CLOSE, NW10

£360,000



19ft Living/ Dining room



10ft Kitchen



Two Bedrooms



Bathroom



Allocated

Requiring updating, a spacious 719 sq.ft two double bedroom first floor flat with a private south facing 17ft wide balcony and allocated off street parking. The property boasts a 19ft living/dining room and benefits from use of a communal garden. The property has scope for cosmetic re-modernisation throughout, with great investment potential.

Abbeyfields Close is a quiet well maintained residential development offering easy access for Hanger Lane (Central Line) & Park Royal (Piccadilly Line) underground stations. The A40 and North Circular are also easily reached from this property for those who prefer to travel by car.

Viewings are highly recommended to view this excellent opportunity to acquire a great investment.

EPC RATING: C
LOCAL AUTHORITY: Ealing
COUNCIL TAX BAND: D
LEASE: 199 years from 1 January 1984

You may wish to instruct us about a related service, including: the sale and letting of residential and commercial property, the provision of mortgage and financial services, conveyancing and property management. Where you choose to use other services, Northfields or its employees may receive a fee or commission which will be disclosed to you.

Abbeyfields Close NW10

Approximate Gross Internal Area
719 sq ft / 66.8 sq m
External Balcony = 139 sq ft / 12.9 sq m

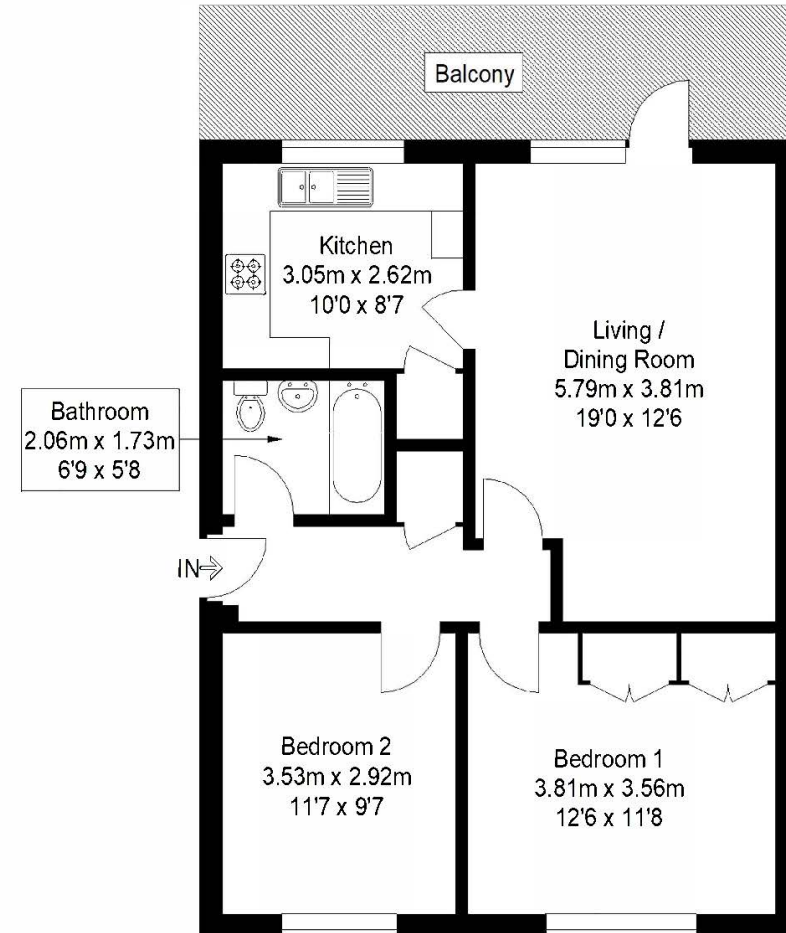
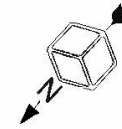

First Floor

719 sq ft / 66.8 sq m

Cube Property Marketing © 2019
Illustration for identification purposes only,
measurements are approximate, not to scale.

Your local independent
award winning estate agents



Pitshanger

1 Albert Terrace
Ealing
London W5 1RL
Sales: 020 8998 3111
E: pitssales@northfields.co.uk

020 8998 3111

www.northfields.co.uk

CONTACT

Us today

TO FIND OUT

MORE